

AT FULL SIZE THIS BAR MEASURES 100mm. ALL SCALES REFERENCED TO FULL SIZE.

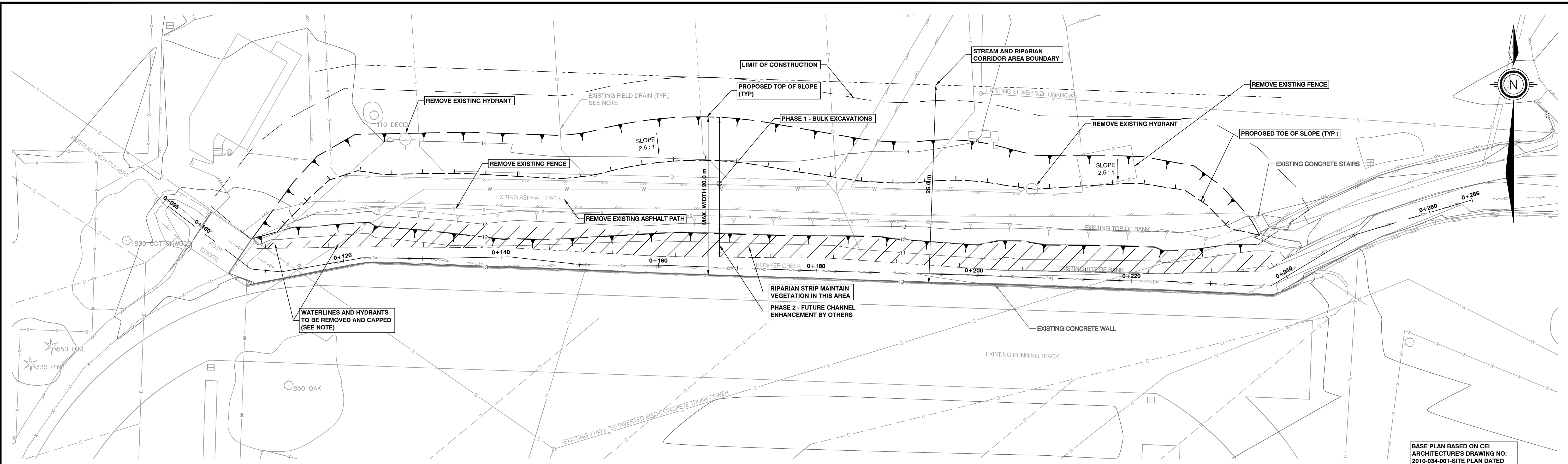

NOTE:
RELOCATION OF EXISTING SERVICES TO BE CONFIRMED BY SCHOOL DISTRICT 61 AND CEI ARCHITECTURE.

BASE PLAN BASED ON CEI ARCHITECTURE'S DRAWING NO: 2010-034-001 SITE PLAN DATED JANUARY 7TH, 2011 AND UPDATED BY J.E. ANDERSON & ASSOCIATES IN SEPTEMBER 2012

PLAN
Scale: 1:250

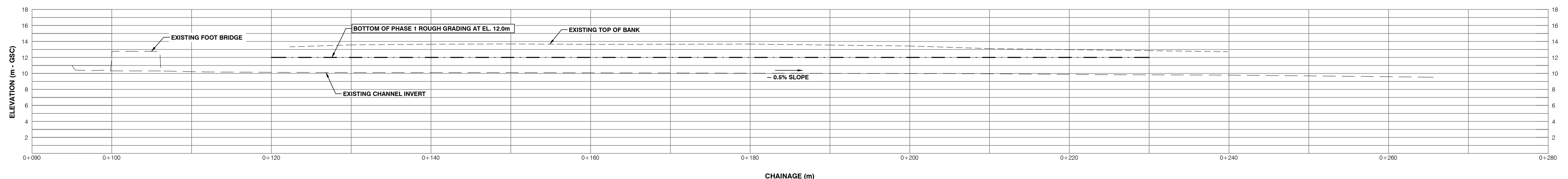

PROFILE
Scale: H 1:250, V 1:250

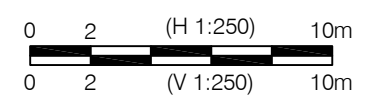

SAVED: 11/14/2012 9:38:41 AM
O:\200-283-329\501-Drawings\Production_Dwg\C01-Plan_Profile.dwg

Issued for	Issue	Date	Issued By
Reference			
Approvals			
Tender			
Permits			
Construction			
Record Drawings			

Rev. No.	Date	Designed	Drawn	Checked	Description of Revision
0	NOV.09/12	CS	PAC		PRELIMINARY DESIGN - ISSUED FOR REQUEST FOR PROPOSAL
1	NOV.14/12	CS	PAC		FINAL RFP ISSUE WITH ADJUSTED TOP OF BANK

Rev. No.	Date	Designed	Drawn	Checked	Description of Revision



**DISTRICT OF OAK BAY
BOWKER CREEK AT OAK BAY HIGH SCHOOL
PHASE 1 - PRELIMINARY ROUGH GRADING
PLAN AND PROFILE**

KWL Project No.: 283-329 Scale: 1:250
 Sheet: 2 of 3 Rev. No.: 1 **SW1**
 Client: CAPITAL REGIONAL DISTRICT