

Ref #	DEPT	NAME OF FACILITY	ADDRESS	LOCATION	Estimated Postal Code	LONGITUDE	LATITUDE	Build Date / Renos	Building Structure	Size of Building (square ft)	Capacity (gallons)	Dimensions (ft x ft)
608.00	Leg & Gen - Building HQ	CRD Headquarters Building- Phase 1	625 Fisgard	Victoria	V8W 1R7	-123.366033	48.429142	2003, 2006	1	42,112		
364.00	Peninsula Wastewater TP	Saanich Peninsula Wastewater Treatment Plant	9055 Mainwaring Road	North Saanich	V8L 5Z1	-123.410442	48.623569	1999	1	20,591		
165.00	Panorama Rec. Centre	Panorama Recreation Centre (440) Arena B	1885 Forest Pk Dr,	North Saanich	V8L 4A3	-123.420697	48.624420	1976, 1995, 2003, 2009	1	107,129		
11.00	Royal Theatre	Royal Theatre	805 Broughton Street,	Victoria	V8W 1E5	-123.362229	48.423176	1913, 1989,2002	1	34,290		
140.00	SEAPARC - Facilities & Recreation	Sooke Arena & Pool Building - Addition of Sooke Arena Gym (2020)	2168 Philips Road,	Sooke	V0S 1N0	-123.708000	48.386125	1976	1	51,440		
24.00	Facilities	Peninsula Health Unit	2170 Mt. Newton X Rd	Central Saanich	V8M 2B2	-123.410647	48.594480	1994	1	26,865		
689.00	Regional Water Supply	Smith Hill Reservoir (Not In Service)	Summit Ave	Victoria	V8T 3T8	-123.352369	48.444821	1950			20,928,331	
860.00	Health Planning	Kings Road School / Office Building	950 Kings Road	Victoria	V8T 1W6	-123.360577	48.437675	circa 1960's	1	35,061		
195.00	Swimming Pool	Rainbow Road Indoor Pool	262 Rainbow Road	Salt Spring Island	V8K 2M3	-123.511737	48.855004	2008	1	13,844		
22.00	Community Health (CHR) Facilities	Victoria Health Unit	1947/1951 Cook Street	Victoria	V8T 3P7	-123.352098	48.431549	1986	1	26,360		
418.00	Regional Water Supply	Office / Administration Center	479 Island Highway	View Royal	V9B 1H7	-123.459399	48.456854	1970, 1990, 2002	1	30,595		
509.00	Regional Water Supply	Haliburton Reservoir	739 Haliburton Rd	Saanich	V8Y 1H7	-123.379940	48.512175	1973			6,003,838	
510.00	Regional Water Supply	Mt. Tolmie Reservoir	Kendal Avenue	Saanich	V8P 1R8 ?	-123.320905	48.454591	1971			5,888,168	
792.00	Library	Saltspring Island Library	129 McPhillips Ave.	Salt Spring Island	V8K 2T6	-123.501221	48.852786	2012	1	14,312		
228.00	Supply	Dean Park Lower Reservoirs #1 and #2	1866 Dean Park Road,	North Saanich	V8L 1C1	-123.421973	48.618191	1975, 1995			600,463	
612.00	Regional Water Supply	Japan Gulch U.V. Plant & Valve chamber	3195 Niagara Main Road	Sooke	V0S 1N0?	-123.572605	48.460778	2003	1	17,599		
166.00	Panorama Rec. Centre	(440) Arena A	1885 Forest Pk Dr	North Saanich	V8L 4A3	-123.419566	48.623302	1996	1	28,308		
9.00	Prov. Court of BC (Family Court)	VIHA Mental Health Unit	1119 Pembroke Street,	Victoria	V8T 1J3	-123.351361	48.431036	1980	1	18,045		
818.00	SWMP - Solid Waste Disposal	Hartland Power Plant	Hartland Road, Landfill,	Saanich	V9E 1L7	-123.461528	48.537464	2004	1	n/a	n/a	
21.00	Community Health (CHR) Facilities	Esquimalt Health Unit	530 Fraser Street	Esquimalt	V9A 6H7	-123.413298	48.429256	1990	1	14,234		
343.10	Ganges Sewer	Ganges Treatment Plant and Treatment Plant B:sewer lift/generator/equipment	104 Seaview Road, Ganges	Salt Spring Island	V8K 2V8	-123.500277	48.851574	various	1	n/a		
67.00	Regional Parks	Selkirk Trestle - GGRT	Waterway	Galloping Goose	V8T 5K7 ??	-123.382171	48.439681	1910, 1997		15, 792		
685.00	Northeast Trunk #2	Trent Pump Station	2339 Trent Street	Victoria	V8R 4Z3	-123.323569	48.433147	2008	1	7,219		
709.00	Regional Water Supply	Skirt Mountain Reservoir	Skirt Mountain	Langford		-123.532034	48.464530	2008		n/a	1,732,722	
708.00	Regional Water Supply	Fulton Reservoir/Pumphouse	Fulton Road	Colwood	V9C 3N2	-123.509449	48.415904	2006	1	578	1,651,500	
246.00	Saanich Peninsula Water Supply	McTavish Upper Reservoir	9080 Cresswell Road,	North Saanich	V8L 5T9 ??	-123.431217	48.628335	1941		n/a	1,775,000	
502.00	Regional Water Supply	Helgesen Reservoir	6776 Helgesen Road	Sooke	V0S 1N0	-123.736672	48.386989	1975, 1998		n/a	1,651,500	
832.00	Northwest Trunk (Macaulay)	Craigflower Pump Station	150 Island Highway	View Royal	V9A 7A7	-123.430534	48.452724	2015	1	6,467		3634

310.10	Northwest Trunk (Macaulay)	Marigold Sewage Storage Tank	901 Marigold Road, Saanich	Saanich	V8Z 4R9	-123.399206	48.468588	2003		n/a	1,750,000
497.00	Regional Water Supply Saanich Peninsula Water	Peacock Reservoirs & valve chambers	637 Peacock Place	52276	V9B 6C3	-123.495266	48.471236	1990, 1997	1	n/a	22,745
234.00	Supply Saanich Peninsula Water	Dean Park Upper Reservoir	1400 Dean Park Road,	North Saanich	V8L 5E5 ??	-123.444657	48.612085	1997		n/a	1,750,000
254.00	Supply Saanich Peninsula Water	Cloake Hill Reservoir	11326 Redbud Place,	North Saanich	V8L 5J9 ??	-123.450446	48.690097	1982		n/a	1,200,000
229.00	Supply	Dean Park Middle Reservoirs #1 and #2	8752 Carmanah Terrace,	North Saanich	V8L 5E5	-123.436030	48.619453	1975, 1996		n/a	470,000
505.00	Regional Water Supply	Sooke Reservoir Head Tank	Sooke Lake Watershed	Sooke	V0S 1N0	-123.691450	48.509518	1992		5,195	
504.00	Regional Water Supply	Sooke Reservoir Screening Tower	Sooke Lake Dam	Sooke	V0S 1N0	-123.701634	48.516935	1971, 1990		1,192	
307.00	Northwest Trunk (Macaulay)	Macaulay Point Pump Station	330 View Point Street,	Esquimalt	V9A 5Y2	-123.406147	48.418634	1970, 1990	1	12,044	
312.00	Northeast Trunk (Clover Point) Saanich Peninsula Water	Clover Point Pump Station	1325 Dallas Road	Victoria	V8S 1A1	-123.349414	48.405435	1976	1	11,379	
236.00	Supply	Bear Hill Water Reservoir	5647 Batu Road	Saanich	V8Z 6K5	-123.402178	48.544233	1996		n/a	1,200,000
426.00	Regional Water Supply	Japan Gulch Treatment Plant	3189 Niagara Main Road	Sooke	V9B 4R6??	-123.580796	48.463827	1986	1	3,370	
317.00	East Coast Interceptor Saanich Peninsula Water	Currie Road Pump Station	2425 Currie Road,	Oak Bay	V8S 3B5	-123.308655	48.420383	1989	1	5,742	
244.00	Supply	McTavish Lower Reservoir	1717 McTavish Rd.,	North Saanich	V8L 5T9	-123.429234	48.629293	1974		n/a	1,000,000
859.00	East Sooke Fire Protection	East Sooke Fire Hall (NEW)	6071 East Sooke Road	Sooke	V9Z 0Z7	-123.669469	48.362856	2015	1	10,912	
287.00	System	Buck Lake Dam	Buck Lake,	North Pender Island	V0N 2M2	-123.301800	48.771056	1970		n/a	
502.10	Regional Water Supply	Helgesen Reservoir (Old)	Helgesen Road	Sooke		-123.728553	48.388915	1975, 1998		n/a	691,000
54.00	Regional Parks	Todd Trestle - GGRT	Kilometer 47	Galloping Goose	V0S 1N0	-123.710029	48.430028	1910 , 1995		3,670	
521.00	Gulf Island Docks	Miners Bay (Dock, Pier, Structures)	Mayne Island	Mayne Island	V0N 2J0	-123.301998	48.852122	1955, 2003		10,552	
61.00	Regional Parks	Gonzales Observatory & outbuildings (tenanted 2017)	302 Denison, Lot A, Sections 19, 47 & 68 Victoria District, Plan 46958	Victoria	V8S 4K3	-123.325104	48.413261	1914	1	4,674	
130.00	Pender Fire Protection	Pender Island Fire Rescue Fire Hall # 1 (351)	(Hall 1)	North Pender Island	V0N 2M1	-123.285798	48.793143	2002	1	6,248	
728.00	Regional Water Supply Northwest Trunk (Macaulay)	Sooke River Road Disinfection Plant Marigold Pump Station, Generator, Odour Building and equipment	2899 Sooke River Road	Sooke	V9Z 0Y1	-123.710219	48.414498	2009	1	4,180	
310.00	SWMP - Solid Waste		901 Marigold Road, Saanich	Saanich	V8Z 4R9	-123.399034	48.468530	1985	1	3,852	
208.00	Disposal	Hartland Road Dropoff Facilities	Hartland Road, Landfill,	Saanich	V9E 1L7	-123.460597	48.533153	2000, 2008		n/a	
664.00	Regional Water Supply	Sun River Estates Reservoir	Sun River Estates	Sooke	V0S 1N0	-123.727633	48.402419	2006			475,500
829.00	Building Inspection	JDF Administration Building (New) office	#3-7450 Butler Road	Otter Point	V9Z 1N1	-123.772292	48.393923	2013	1	4,598	
56.00	Regional Parks	Swan Trestle - LOCHSIDE	Saanich Spur (Lochside Trail)	Lochside	V81 4C1	-123.366145	48.464589	1950, 1995		5,784	
499.00	Regional Water Supply	Walfred Reservoir	ref plan 43930	2600 right of way	V9C 2X3	-123.516951	48.424627	1973, 1986, 1994		n/a	76,102
55.00	Regional Parks	Charters Trestle - GGRT	Kilometer 45	Galloping Goose	V0S 1N0	-123.705406	48.414668	1910, 1995		4,368	
663.00	East Sooke Fire Commission	East Sooke Community Centre (Old East Sooke Fire Hall)	1397 Coppermine Road	Sooke	V0S 1N0	-123.677934	48.363342	1986	1	5,410	
629.00	Regional Water Supply	Bear Mountain Reservoir #1	Bear Mountain	Langford	n/a	-123.524162	48.473819	2003		n/a	330,216

132.10	Otter Point Fire Protection	Otter Point Training Centre	3727 Otter Point Road,	Sooke	V9Z 0K1	-123.793603	48.386370	1995	1	960	
132.00	Otter Point Fire Protection	Otter Point Fire Hall (353)	3727 Otter Point Road,	Sooke	V9Z 0K1	-123.793174	48.386349	1975	1	3,791	
217.70	Disposal	North Leachate Pump Station (Lagoon & Pump Station)	Hartland Road, Landfill,	Saanich	V9E 1L7	-123.461497	48.539994	1996	1	132	
130.20	Pender Fire Protection	and Live Fire Training Facility Structure	(Hall 1)	North Pender Island	V0N 2M1	-123.285787	48.793150	2016, 2018	1		
52.00	Regional Parks	Bracken Building, Headquarters, Building B	490 Atkins Avenue, Langford	Mill Hill	V9B 2Z8	-123.482496	48.453060	1935, 1985	1	4,379	
520.20	Regional Water Supply	PRV SITE - SUPPLY - Humpback	Humpback	Sooke		-123.554851	48.448366	1996	1	480	
632.00	Regional Water Supply	Silver Spray Reservoir	Silver Spray Drive	East Sooke	n/a	-123.707018	48.349722	2004		n/a	185,000
802.00	Galiano Island Library Service	Galiano Island Library / Community Use Building	2-1290 Sturdies Bay Rd. Lot C, Plan17667, Section 7	Galiano Island	V0N 1P0	-123.335119	48.88575	2013	1	2,622	
53.00	Regional Parks	Cedar Building, Planning, Building C	490 Atkins Avenue, Langford	Mill Hill	V9B 2Z8	-123.482841	48.452954	1995	1	4,274	
128.00	Recreation	Willis Point Fire Hall & Rec. Ctre. (350)	6933 Willis Point Rd., Prov. Territory	Willis Point	V9E 2A1	-123.480933	48.570838	1976	1	4,540	
347.00	System	Schooner Wastewater Treatment Facility	27126 Schooner Way	North Pender Island	V0N 2M2	-123.304613	48.768152	1975	1	n/a	
141.80	Recreation	SEAPARC - Facilities & Skate Park	6522 Throup Rd.	Sooke	V0S 1N0	-123.715725	48.385965	2000		28,298	
50.00	Regional Parks	Arbutus Building, Operations, Building A	490 Atkins Avenue, Langford	Mill Hill	V9B 2Z8	-123.482131	48.453131	1995	1	4,723	
529.00	Gulf Island Docks	Hope Bay (Dock, Pier, Structures)	Pender Island	Pender Island	V0N 2M2	-123.275379	48.803260	1955		5,732	
500.00	Regional Water Supply	Townview Reservoir	Townview Terrace	Colwood	n/a	-123.507343	48.421549	1984, 1994		n/a	144,238
143.00	Recreation	Community and Recreation Centre	Parkinson Rd & Deering Rd	Port Renfrew	V0S 1K0	-124.400378	48.557118	1962	1	3,502	
144.60	Protection	Port Renfrew Fire Hall	6637 Deering Road	Port Renfrew	V0S 1K0	-124.400016	48.557432	2009	1	2,435	
531.00	Gulf Island Docks	Lyall Harbour (Dock, Pier, Structures)	Saturna Island	Saturna Island	V0N 2Y0	-123.201133	48.797935			n/a	
496.10	Regional Water Supply	Rocky Point Reservoir (2)/ CL2 Station	4775 Rocky Point Road	Metchosin	n/a	-123.562026	48.365222	1990, 1995, 2002	1	n/a	63,210
223.50	Saanich Peninsula Water Supply	Dawson Upper Reservoir	1185 Benvenuto Dr.,	Central Saanich	V8M 1J6	-123.448686	48.564892	1998		n/a	230,000
526.00	Gulf Island Docks	Port Washington (Dock, Pier, Structures)	N. Pender Island	North Pender Island	V0N 2M2	-123.320529	48.812746	1955, 2003		5,147	
865.00	Information Systems	Radio Tower (Former "Bell Mobile Tower")	1350 Mt. McDonald Road	Wilderness Park		-123.568895	48.442225	circa 1990's		n/a	
503.00	Regional Water Supply	Japan Gulch Screening Tower	Japan Gulch Reservoir	Sooke	V0S 1N0	-123.580394	48.463489	1970		1,488	
205.00	Disposal	Hartland Road Administration Bldg	Hartland Road, Landfill, 2795-B Sheringham Point Road	Saanich	V9E 1L7	-123.459195	48.533826	1986, 1997	1	2,614	
133.60	Shirley Fire Protection	Shirley Fire Hall		Shirley	V9Z 1G4	-123.903765	48.388855	1989	1	2,008	
494.00	Regional Water Supply	East Sooke Reservoir	Coppermine Road	East Sooke	n/a	-123.681148	48.360516	1984			119,934
838.00	N. Galiano Fire Protection	North Galiano Firehall (NEW)	19400 Porlier Pass Road	Galiano Island	V0N 1P0	-123.561565	48.973477	2014	1	2600	
690.20	Wilderness Mtn Wtr Svc	Wilderness Mountain Reservoir old & new	706 Cains Way	Sooke	V9Z 1C5	-123.607838	48.356601	1975		n/a	73323.91
522.00	Gulf Island Docks	Sturdies Bay (Dock, Pier, Structures)	Sturdies Bay	Galiano Island	V0N 1P0	-123.315310	48.876890	2003, 2004		2,783	
137.00	Pender Fire Protection	South Pender Fire Hall # 3	Gowland Pt Road	South Pender Island	V0N 2M3	-123.219893	48.744557	1988, 2002	1	2,410	
28.00	Regional Parks	728 Beaver Lake Office	728 Beaver Lake Road	Saanich	V8Z 6K2	-123.398437	48.508987	1944, 1985	1	3,664	
196.90	Mayne Island Comm. Parks & Rec	Mayne Island Library	411 Naylor Rd.	Mayne Island	V0N 2J2	-123.299278	48.850493	2001	1	2,315	

345.00	Maliview Estates Sewer System	Maliview Sewage Treatment Plant, storage building	323 Maliview Drive @ Walters Hook	Salt Spring Island	V8K 1B1	-123.524620	48.910460	1970	1	322	
530.00	Gulf Island Docks	Fern Wood Dock (Dock, Pier, Structures)	End of Fern Wood Rd.	Salt Spring Island	V8K 1B3	-123.532891	48.916350	2003, 2004		3,782	
836.00	Magic Lake Estates Water System	Magic Lake Treatment Plant (DAF)	47284 Schooner Way,	North Pender Island	V0N 2M2	-123.279759	48.763786	2012	1	3,544	
889.00	Regional Water Supply	Japan Gulch Chlorine Storage Building (New)	3182 Niagara Main	Japan Gulch		-123.570926	48.461159	2018	1	1,990	
56.10	Regional Parks	Interurban Bridge - GGRT	Kilometer 5	Galloping Goose		-123.394695	48.458561	1997		3,900	
293.00	Saturna Island Water System (Lyll Harbour)	L.H./B.C. Money Lake Dam	105 Harris Road,	Saturna Island	V0N 2Y0	-123.178982	48.786143	1970			
180.00	Salt Spring Island - Comm Parks & Rec	Rotary Marine Park	141 Lower Ganges Rd	Salt Spring Island	V8K T2T	-123.499680	48.854084	1990		n/a	
336.00	Peninsula Wastewater TP	Sidney Pump Station	9576 Fifth Street,	Sidney	V8L 2W5	-123.400696	48.643226	1973	1	2,320	
175.10	Parks & Rec	Kanaka Skateboard Park	118 Aldous Road	Salt Spring Island	V8K 2R7	-123.504061	48.856046	2000		12,600	
320.00	East Coast Interceptor	Rutland Pump Station	cove	Oak Bay	V8R 3R7	-123.292108	48.443111	1980	1		
527.00	Gulf Island Docks	Port Browning (Dock, Pier, Structures)	North Pender	North Pender Island	V0N 2M2	-123.272400	48.776380	1955		3,171	
96.00	Regional Parks	Six Mile Bridge - GGRT	Kilometer 11	Galloping Goose		-123.463939	48.458185	1997		1,830	
216.10	Disposal	Hartland Contractors Workshop (New)	Hartland Road, Landfill	Saanich	V9E 1L7	-123.459190	48.533817	2011	1	3,250	
211.00	Disposal	H.H.W. Facility - Canopy	Hartland Road, Landfill,	Saanich	V9E 1L7	-123.460012	48.532332	2009		4740	
135.00	Pender Fire Protection	Magic Lake Estates Fire Hall #2	Schooner Way & Ketch Rd	North Pender Island	V0N 2M2	-123.285406	48.766640	1985	1	1,640	
496.00	Regional Water Supply	Deer Park Reservoir & chamber	4945 Deer Park Trail	Metchosin	V9C 4J5	-123.578417	48.373697	2000	1	n/a	47,022
		Portlock Park Yard (Tennis Courts/Storage Sheds/Batting Cage/Wells & Reservoirs/Containers/Basketball & Lacrosse Court/Playground & Fitness Equipment/Signage)/ 20x20 Marquee Tent									
175.50	Salt Spring Island - Comm Parks & Rec	Swartz Bay (Dock, Pier, Structures)	145 Vesuvius Bay Rd.	Salt Spring Island	V8K 1K3	-123.529822	48.872736	various		n/a	
524.00	Gulf Island Docks	Swartz Bay (Dock, Pier, Structures)	Swartz Bay	North Saanich		-123.407389	48.687705	1965		2,947.50	
112.00	Regional Parks	Washroom Building - Thetis Main Beach	Thetis Lake	Thetis Lake Park		-123.468420	48.464736	1972	1	1,450	
319.00	East Coast Interceptor	Humber Station	End of Humber Road	Oak Bay	V8R 3T1	-123.292409	48.449103	1980	1	350	
182.00	Salt Spring Island - Comm Parks & Rec	Grace Point Boardwalk	Fulford-Ganges,	Salt Spring Island	V8K 2L6	-123.497518	48.852597	1994		n/a	
235.00	Supply	Hamsterly Pump Station & Meter Station	5420 Hamsterly Road,	Saanich	V8Y 1S4 ??	-123.390082	48.535132	1996	1	2,280	
427.00	Regional Water Supply	FOC Annex	2995 Sooke Lake Rd	Sooke	n/a	-123.641666	48.575974	1972	1	1,624	
321.00	East Coast Interceptor	Penrhyn Station	2212 Penrhyn St.	Saanich	V8N 1G2 ??	-123.294554	48.460508	1996	1	1,794	
83.00	Regional Parks	Lagoon	3925 Metchosin Rd.	Witty's Lagoon	V9C 4A5	-123.512881	48.391889	1980	1	1,833	
439.00	Regional Parks	Radio Tower	1350 Mt. McDonald Road	Wilderness	V0S 1N0	-123.568952	48.442073	1996			
634.00	Beddis Water	Beddis Water Treatment Plant	Road	Salt Spring Island	V8K 2C2	-123.464957	48.816052	2008	1	792	
141.50	SEAPARC - Facilities & Recreation	Ball Field and Apparatus/Bike Jump Park	2168 Philips Road, Hamsterly Road, Elk/Beaver Lake	Sooke	V0S 1N0	-123.709271	48.385464	2000 -2002		n/a	
30.00	Regional Parks	Washroom - Hamsterly Beach	Lake	Elk/Beaver Lake, Saanich	V8Z 3J9	-123.390980	48.535212	1959	1	1,514	
890.00	Regional Water Supply	Japan Gulch Ammonia Storage Building (New)	3093 Niagara Main	Japan Gulch		-123.566040	48.459606	2018	1	1,684	

	Salt Spring Island - Comm										
179.00	Parks & Rec	Centennial Park Washroom Building (NEW)	off Fulford-Ganges Rd.,	Salt Spring Island	V8K 1Z6	-123.498637	48.852113	1980	1	441	
318.00	East Coast Interceptor	Currie Road Lift Station	2425 Currie Road,	Oak Bay	V8S 3B5	-123.308606	48.420382	1980	1	350	
76.00	Regional Parks	Humpback Reservoir Building - Two Story	3034 Humpback Road	Sooke Hills Wild.	V9B 5Y5	-123.554771	48.448645	1950	1	1,920	
288.00	Magic Lake Estates Water System	Magic Lake Reservoir #1 175,000 I.G & valve chamber	3711 Frigate Rd	North Pender Island	V0N 2M2	-123.281685	48.771222	1975	1	n/a	150,000
218.00	SWMP - Solid Waste Disposal	Hartland Interpretive Centre	Hartland Road, Landfill,	Saanich	V9E 1L7	-123.459028	48.534322	1960, 2010	1	1,718	
515.10	Regional Water Supply	Sooke Caretakers House (generator)	Sooke Lake Road	Sooke	V0R 2W3	-123.641715	48.576006	2001	1	1,528	
512.00	Regional Water Supply	Stelly's PumpStation	build & contents	Central Saanich	V8M 1Y3	-123.403096	48.579878	1988	1	2,472	
361.00	Peninsula Wastewater TP	Keating Pump Station	7640 Central Saanich Rd.	Central Saanich		-123.403800	48.590913	2000	1	1707	
134.00	N. Galiano Fire Protection	North Galiano Fire Hall #2 (359)	25 Retreat Cove Rd,	North Galiano Island	V0N 1P0	-123.492863	48.939021	1989, 1990	1	1,408	
175.00	Parks & Rec	Portlock Park Office and Washrooms	145 Vesuvius Bay Rd.,	Salt Spring Island	V8K 1K3	-123.530994	48.872716	1980-1995		1,566	
625.00	Regional Parks	Millstream Creek Bridge - GGRT	Galloping Goose, Km 12	Galloping Goose	n/a	-123.473396	48.447484	2002		2,394	
609.00	Surfside Park Estates (Mayne)	Surfside Park Est. Water treatment plant and well pumphouse	Wood Dale Drive	Mayne Island	V0N 2J0	-123.313598	48.842565	1972, 2006	1	148	
436.00	Regional Water Supply	Radio Tower	Butchart Lake	Goldstream	n/a	-123.638696	48.529486	circa 2000		n/a	
47.00	Regional Parks	Francis/King; Elsie King Boardwalk	1710 Munn Road	Francis/King	V9E 1H7	-123.443974	48.485493	1985		2,460	
650.00	Regional Water Supply	Field Operations Centre Storage Building	3041 Niagara Main Rd.	Sooke	n/a	-123.564444	48.459369	2007	1	2819	
615.00	Regional Parks	Colwood Creek Bridge - GGRT	Km 17 Galloping Goose	Colwood	n/a	-123.516054	48.435555	2003		1,572	
811.00	Regional Water Supply	Erinan Pump Station	Erinan @ West Coast Road	Sooke	V9Z 0R8	-123.753451	48.372477	2013	1	290	
523.00	Gulf Island Docks	Piers Island (Dock, Pier, Structures)	Piers Island	Piers Island		-123.412353	48.701147	1960, 2003		2,675	
517.00	Regional Water Supply	Field office WSM @ Goldstream	3051 Niagara Main Road	Sooke	n/a	-123.564353	48.459419	2000	1	2,680	
362.00	Peninsula Wastewater TP	Turgoose Pump Station	2486 Mt. Newton Cross Road	Central Saanich	V8M 2B8	-123.392964	48.594175	2000	1	198	
207.20	SWMP - Solid Waste Disposal	Hartland Auto Scale (opposite Admin bldg)	Hartland Road, Landfill,	Saanich	V9E 1L7	-123.459504	48.533633	Mid 80's		n/a	n/a
498.00	Regional Water Supply	Stirrup Reservoirs (2)	3984 Stirrup	Metchosin Sooke Hills	V9C 4A3	-123.533644	48.397146	1980, 1997		n/a	28,055
438.00	Regional Parks	Transmitter Building	1350 Mt. McDonald Road	Wilderness	V0S 1N0	-123.569021	48.442099	1995	1	276	
289.00	Magic Lake Estates Water System	Magic Lake Reservoir #2 75,000 I.G. & valve chamber	4628 Ketch Rd	North Pender Island	V0N 2M2	-123.291965	48.770032	1980	1	n/a	90,000
528.00	Gulf Island Docks	Retreat Cove (Dock, Pier, Structures)	Galiano Island	Galiano Island	V0N 1P0	-123.501187	48.940115	1955, 2003		1,750	
245.00	Saanich Peninsula Water Supply	Storage Building, Chlorine Storage Shed & Workshop	1717 McTavish Rd.,	North Saanich	V8L 5T9	-123.428542	48.629479	1995	1	2,280	
525.00	Gulf Island Docks	Montague Harbour (Dock, Pier, Structures)	Galiano Island	Galiano Island	V0N 1P0	-123.391453	48.892010	1955		1,573	
810.00	Regional Water Supply	Helgesen Pump Station (New)	6776 Helgesen Road	Sooke	V0S 1N0	-123.732549	48.388125	2013	1	1,000	
179.20	Salt Spring Island - Comm	Centennial Park Boardwalk & Viewing Platform and two benches and artwork	off Fulford-Ganges Rd.	Salt Spring Island	V8K 1Z6	-123.498572	48.852218	1980		n/a	
803.00	Regional Water Supply	Walfred Pump Station	925B Walfred Road	Langford	V9C 2P3	-123.517369	48.429206	2013	1	1,122	
179.30	Salt Spring Island - Comm	Centennial Park Yard (Playground (NEW) /Flag Pole & Benches/Cenotaph/Miscellaneous)	off Fulford-Ganges Rd.,	Salt Spring Island	V8K 1Z6	-123.498637	48.852113	various		n/a	
37.00	Parks & Rec	Nature Center - Beaver Beach	Elk Lake Drive, Saanich	Saanich		-123.390391	48.509706	1959	1	1514	
45.00	Regional Parks	Francis/King Nature Centre	1710 Munns Road	Francis/King	V9E 1H7	-123.444498	48.484191	1975-1985	1	867	
78.00	Regional Parks	Vehicle Bridge - Beaver Lake Road	Beaver Lake Road	Beaver Lake Road	V8Y 2T6	-123.393794	48.507370	1975		850	

	SWMP - Solid Waste									
219.00	Disposal	Hartland Biosolids Curing Building	Hartland Road, Landfill,	Saanich	V9E 1L7	-123.466955	48.539969	2004	1	6,935
79.00	Regional Parks	Veitch Creek Trestle Bridge	Kilometer 36	Galloping Goose		-123.632361	48.377347	1997		1,876
80.00	Regional Parks	Ayum Creek Trestle Bridge	Kilometer 40	Galloping Goose		-123.662750	48.393516	1990		1,890
207.30	SWMP - Solid Waste Disposal	Hartland Manned Scale	Hartland Road, Landfill,	Saanich	V9E 1L7	-123.460390	48.532889			n/a
308.00	Northwest Trunk (Macaulay)	Lang Cove Pump Station	680 Constance Ave.,	Esquimalt	V9A 6N7	-123.417904	48.432981	1995	1	967
322.00	East Coast Interceptor	Hood Pump Station	577 Beach Drive,	Oak Bay	V8S 2M6	-123.307208	48.411272	1980	1	144
128.10	Willis Point Fire Protect & Recreation	Willis Point Fire Apparatus Building (NEW)	6933 Willis Point Rd., Prov. Territory	Willis Point	V9E 2A1	-123.480587	48.571164	2013	1	1,630
129.10	Willis Point Fire Protect & Recreation	Willis Point Fire Annex	6933 Willis Point Rd.	Willis Point	V9E 2A1	-123.481432	48.570667	1960, 2002	1	960
658.00	Galiano Parks & Rec	Galiano Skate Park	Burril Road	Galiano Island	V0N 2J0	-123.318251	48.870342			4,500
358.00	CRD Retail Water	Port Renfrew Sewage Treatment Plant	6682 Queesto Drive	Port Renfrew	V0S 1K0	-124.403576	48.558058	1961	1	1,133
442.00	Regional Water Supply	Water Samplers Office	2955 Sooke Lake Road	Sooke	V9B 4R5	-123.561683	48.459023	1975	1	1,104
313.00	Northeast Trunk (Clover Point)	Harling Point Pump Station	2171 Crescent Road,	Oak Bay ref plan 40335	V8S 2H4	-123.323617	48.406930	1981	1	128
493.00	Regional Water Supply	Henlyn Reservoir	7194 Henlyn Drive, Sooke	easeement	V0S 1N0	-123.755947	48.381028	1997		61,600
230.00	Saanich Peninsula Water Supply	Dean Park Middle Pump Station	8752 Carmanah Terrace,	North Saanich	V8L 5E9	-123.436013	48.619551	1996	1	1,260
684.00	S.S.I. Septage/Composting	Burgoyne Septage Facility (Includes In- Ground Sewage Pump, 4 Steel Tanks)	133 Burgoyne Bay Road	Salt Spring Island	V8K 2A6	-123.509775	48.784474	1993, 2008		2000
610.10	Skana Water (Mayne)	reservoir	491 Waugh Road	Mayne Island	V0N 2J0	-123.289709	48.868924	1970		64
215.10	SWMP - Solid Waste Disposal	Hartland Operations Workshop #2	Hartland Road, Landfill,	Saanich	V9E 1L7	-123.461044	48.532597	2009	1	1,300
737.00	Peninsula Wastewater TP	SPWWTP Thermal Recovery Building	9055 Mainwaring Road	North Saanich	V8L 5Z1	-123.413567	48.628363	2011	1	1,293
628.00	Regional Water Supply	Bear Mountain Pump Station # 2	Bear Mountain	Langford	n/a	-123.524080	48.474400	2004	1	530
813.00	Highlands / Fernwood Water - SSI	Water Treatment Facility - All Buildings	165 Maycock Road,	Salt Spring Island	V8K 1N2	-123.543388	48.898341	2012	1	1480
691.00	Regional Water Supply	Flatman Pump Station	Road)	Langford	V9C 2Y5	-123.531363	48.422429	2006	1	958
738.00	Regional Parks	Francis/King - Rental House	1710 Munn Road	Francis/King	V9E 1J2	-123.441233	48.480418	1975, 1989	1	701
196.30	Mayne Island Comm. Parks & Rec	Cookhouse	Dinner Bay Park	Mayne Island	V0N 2J2	-123.317433	48.833597	2007		1,540
353.00	Magic Lake Estates Sewer System	Schooner Way Pump Station	27125 Schooner Way,	North Pender Island	V0N 2M2	-123.305262	48.767859	1982	1	72
302.00	Highlands / Fernwood Water - SSI	FernWood Reservoir #1 & #2 and valve chamber	212 Langs Road,	Salt Spring Island	V8K 1N3	-123.541366	48.902293	1975, 1995	1	34000
352.00	Magic Lake Estates Sewer System	Cutlass Court Pump Station	3805 Cutlass Court	North Pender Island	V0N 2M2	-123.291334	48.761298	1978	1	72
56.20	Regional Parks	Wilkinson Bridge - GGRT	Kilometer 7	Galloping Goose		-123.416643	48.464586	1997		1035
354.00	Magic Lake Estates Sewer System	Masthead Pump Station	3603 Masthead Crescent,	North Pender Island	V0N 2M2	-123.299537	48.775812	1982	1	72
355.00	Magic Lake Estates Sewer System	Capstan Pump Station	3730 Capstan Lane,	North Pender Island	V0N 2M2	-123.293335	48.764550	1982	1	72
236.10	Saanich Peninsula Water Supply	Bear Hill Control Building	5647 Batu Road	Saanich	V8Z 6K5	-123.398327	48.541821	1996	1	1030
350.00	Magic Lake Estates Sewer System	Buccaneers Road Pump Station	4720 Buccaneers Road	North Pender Island	V0N 2M2	-123.285263	48.763752	1982	1	72

742.00	Regional Water Supply	Iron Mine Rechlorination Station	Entrance)	East Sooke	V9Z 1A8	-123.707426	48.348869	2011	1	917
106.00	Regional Parks	Fishing Pier/Aluminum Gangway	V&S Trail at Bear Hill Road	Elk/Beaver Lake		-123.409787	48.532985	1994		1,180
351.00	Magic Lake Estates Sewer System	Galleon Way Pump Station	2690 Galleon Way,	North Pender Island	V0N 2M2	-123.293873	48.771826	1970	1	
299.00	Port Renfrew Water SWMP - Solid Waste	Reservoir and Control Valve Chamber	Port Renfrew	Port Renfrew	V0S 1K0	-124.403297	48.554787	2000	1	123,200
217.72	Disposal	North Leachate Underground Valve Station	Hartland Road, Landfill,	Saanich	V9E 1L7	n/a	n/a	1993	1	600
283.00	Magic Lake Estates Water System	Buck Lake RWPS (Raw Water Pump Station)	2732 Spyglass Road,	North Pender Island	V0N 2M2	-123.302877	48.771408	1960	1	
655.00	Port Renfrew Water	(New)	Port Renfrew	Port Renfrew	n/a	-124.374639	48.567119	2017	1	80
683.20	Fulford Water	Fulford Reservoir	203 Southridge Drive	Salt Spring Island	V8K 1Y9	-123.448155	48.776180	2009		n/a
250.00	Saanich Peninsula Water Supply	McTavish Upper Valve PRV Chambers 1&2	9080 Cresswell Road,	North Saanich	V8L 5T9 ??	-123.430741	48.628597	1981, 1996	1	1064
737.10	Peninsula Wastewater TP Sticks Allison Water (Galiano)	Panorama Thermal Recovery Building	1885 Forest Pk Dr,	North Saanich	V8L 4A3	-123.422873	48.625348	2011	1	254
305.00	Regional Water Supply	Reservoir - Sticks Allison	120 Galiano Way	Galiano Island	V0N 1P0	-123.369039	48.903977	1992		60
627.00	Shirley Fire Protection	Bear Mountain Pump Station #1	Bear Mountain	Langford	n/a	-123.508159	48.470103	2004	1	555
133.56	Cedar Lane Water (SSI)	Hydrant	Road	Shirley	V9Z 1G4	-123.903311	48.38909	2016		n/a
679.00	Regional Water Supply	Reservoir	123 Mansell Road	Salt Spring Island	V8K 1P9	-123.495971	48.871489	1990, 2008	1	
650.10	Saanich Peninsula Water Supply	Field Operations Centre	Boathouse	Sooke	n/a	-123.699125	48.527327	2007	1	1420
227.00	SWMP - Solid Waste	Dean Park Lower Pump Station	1866 Dean Park Road	North Saanich	V8L 1C1	-123.421858	48.618356	1976, 1980	1	907
217.80	Disposal	South Leachate Pump Station	Hartland Road, Landfill,	Saanich	V9E 1L7	-123.460009	48.533801	1995	1	n/a
686.00	Regional Water Supply	Pelican Pump Station	Pelican Drive	Colwood	V9C 0A4	-123.501001	48.399631	2007	1	580
82.00	Regional Parks	Rental House - Bear Hill Regional Park	5920 Patricia Bay Hwy	Bear Hill Park	V8Y 1T2	-123.391997	48.545756	1950	1	625
572.50	Comm. Parks & Rec	Heart Trail/Ketch/Prior Park - Shed/Workshop	Ketch Rd	North Pender Island	V0N 2M2	n/a	n/a	circa 1960's	1	1,600
343.00	Ganges Sewer	Ganges Wastewater Treatment Plant - equipment & Storage	104 Seaview Road, Ganges,	Salt Spring Island	V8K 2V8	-123.501220	48.851667	1986	1	1,166
341.00	Ganges Sewer	Manson Road Pump Station	117 Purvis Lane, Ganges	Salt Spring Island	V8K 2S5	-123.499707	48.853431	1986	1	56
342.00	Ganges Sewer	Harbour House Pump Station	119 Upper Ganges Road,	Salt Spring Island	V8K 2Y3	-123.501650	48.859378	1986	1	
616.00	Regional Parks	Matheson Bridge - GGRT	31 Galloping Goose		n/a	-123.594297	48.364651	2003		576
683.00	Fulford Water	Fulford Water Treatment Plant	203 Southridge Drive	Salt Spring Island	V8K 1Y9	-123.446141	48.775892	2008	1	804
875.00	Magic Lake Estates Water System	Buck Lake Storage	2732 Spyglass Road,	North Pender Island	V0N 2M2	-123.303673	48.771184	2014	1	
256.00	Saanich Peninsula Water Supply	Low Road Pump Station	8801 E. Saanich Road	North Saanich	V8L 1L2	-123.411936	48.619208	1975	1	835
57.00	Regional Parks	Brett Road Bridge - LOCHSIDE	Saanich Spur (Lochside Trail)	Lochside	V81 2Z7	-123.371107	48.460962	1950, 1995		984
514.00	Regional Water Supply	Alderley PRV Stn	build & contents	Saanich	V8Y 1X8	-123.385887	48.540095	1996	1	594
253.00	Saanich Peninsula Water Supply	Deep Cove Pump Station	10775 West Saanich Road,	North Saanich	V9E 2G4	-123.457517	48.674626	1986, 2010	1	460
611.00	Cedars of Tuam	Cedars of Tuam Water System: Well, Treatment and Reservoir	184 Roland Road	Salt Spring Island	V8K 2B7	-123.439058	48.748203	1975		77
175.20	Salt Spring Island - Comm Parks & Rec	Portlock Park Camp Building (Portable)	145 Vesuvius Bay Rd.,	Salt Spring Island	V8K 1K3	-123.529833	48.872743		1	12,000

299.10	Port Renfrew Water Highlands / Fernwood	Port Renfrew Treatment Plant	Port Renfrew	Port Renfrew		-124.372654	48.566774	1965, 2000	1	309	
280.00	Water - SSI Highlands / Fernwood	Highlands Upper Reservoir and Pumphouse	242 Trincomali Heights Road,	Salt Spring Island	V8K 1M9	-123.528822	48.892740	1980, 1983	1	96	12,000
279.00	Water - SSI Saturna Island Water	Highlands Middle Reservoir & Pumphouse	134 Trincomali Heights Road,	Salt Spring Island	V8K 1M8	-123.531110	48.894813	1980	1	108	30,000
291.10	System (Lyll Harbour)	L.H./B.C. Reservoir	100 Harris Road,	Saturna Island	V0N 2Y0	-123.180417	48.792827	2012		n/a	40,224
679.10	Cedar Lane Water (SSI) Salt Spring Island - Comm	Cedar Lane - Well #5	123 Mansell Road	Salt Spring Island	V8K 1P9	-123.495786	48.871418	1970	1	75	
183.00	Parks & Rec Saanich Peninsula Water	Maintenance Building	210 Kanaka Road,	Salt Spring Island	V8K 2A9	-123.509256	48.855761		1		
223.00	Supply SWMP - Solid Waste	Martindale Pump Station	2607 Martindale Road,	Central Saanich	V8M 1Y2	-123.389731	48.561675	1975	1	507	
213.00	Disposal	Hartland Water Reservoir	Hartland Road, Landfill,	Saanich	V9E 1L7	-123.458161	48.532730	1988		n/a	
483.00	Regional Water Supply	Silverstone Way Pump station	Terrace	Langford	V9B 6A7	-123.477387	48.452097	2005	1	470	
520.50	Regional Water Supply Saanich Peninsula Water	PRV SITE - SUPPLY	Beaver Lake	Saanich		-123.385441	48.511549	1990	1	387	
262.00	Supply Salt Spring Island - Comm	Mt. Newton PRV	7797 Central Saanich Rd	Central Saanich	V8M 1X5	-123.403648	48.593962	1975	1	433	
191.00	Parks & Rec	Ganges Public Pathway (in town)	Salt Spring Island	Salt Spring Island		-123.502372	48.851957	1990		n/a	
690.30	Wilderness Mtn Wtr Svc	Wilderness UV/Filtration Building	706 Cains Way	Sooke	V9Z 1C5	-123.607849	48.356609	1975, 2012	1	192	
475.00	Regional Water Supply	Rocky Point pumphouse	nr. 4775 Rocky Point Rd	Metchosin	V9C 4G1	-123.550621	48.368506	1975	1	225	
304.00	Beddis Water	Sky Valley Reservoir - Beddis	331 Sky Valley Road	Salt Spring Island	V8K 2C3	-123.463309	48.819857	1980			10,000
435.00	Regional Water Supply Salt Spring Island - Comm	Pumphouse - Ammonia Bldg. & chamber	Sooke	road right of way	V0S 1N0	-123.704676	48.406574	1975	1	448	
175.05	Parks & Rec	Portlock Park Picnic Shelter	145 Vesuvius Bay Rd.,	Salt Spring Island	V8K 1K3			2012			
520.30	Regional Water Supply	PRV SITE - SUPPLY	Millstream/Atkins	Langford		-123.494962	48.447582	2001	1	330	
698.00	Regional Water Supply	Burnside Pressure Regulating Station	Helmcken & Burnside Road	View Royal	n/a	-123.423917	48.468858	2007	1	330	
657.00	Regional Water Supply Magic Lake Estates Water	Sun River Estates Pump Station		Sooke	V9Z 0Y4	-123.721469	48.397449	2006	1	323	
286.00	System Saanich Peninsula Water	Magic Lake Pump Stn.	4720 Buccaneers Rd.	North Pender Island	V0N 2M2	-123.286826	48.765645	1990	1	368	
238.00	Supply	Meadowbank Control Chamber	1942 Meadowbank Road	Central Saanich	V8M 119	-123.418204	48.570661	1996	1	420	
614.00	Regional Water Supply Saanich Peninsula Water	Watkiss PRV Station	Watkiss Way & Marler Dr	Esquimalt	V9B 5Z6	-123.453694	48.461813	2003	1	315	
678.00	Supply	Tsawout Meter Chamber	Central Saanich Road	Central Saanich	V8M 2G6	-123.403349	48.586805	1995	1	360	
634.10	Beddis Water	Beddis Water Treatment Pumphouse		Salt Spring Island	V8K 2C1	-123.464793	48.815917	1990, 2008	1	400	
466.00	Regional Water Supply	Helgesen Pumphouse	6776 Helgesen Road	Sooke	V0S 1N0	-123.734414	48.387324	1997	1	358	
472.00	Regional Water Supply Saturna Island Water	Langvista Pumphouse	629 Langvista Dr.	Langford	V9B 5N2	-123.484090	48.458602	1979, 2003	1	358	
291.00	System (Lyll Harbour) SWMP - Solid Waste	L.H./B.C. Lower Filter/Chlor Station & Storage Bldg	100 Harris Road,	Saturna Island	V0N 2Y0	-123.180394	48.792843	1980, 1999	1		
207.10	Disposal	Hartland Road - Weigh Scale Office # 2	Hartland Road, Landfill,	Saanich	V9E 1L7	-123.460389	48.532875	2002	1	200	
470.00	Regional Water Supply Saanich Peninsula Water	Coppermine Pumphouse #2	(1313A Coppermine Rd.)	East Sooke	V9Z 1B2	-123.678162	48.359623	1984	1	140	
252.00	Supply	Mills Road PRV Chamber	Mills Road,	North Saanich	V8L 5Y3	-123.417221	48.655220	1982	1	220	
471.00	Regional Water Supply	Andover Pumphouse	6300 Andover Road	East Sooke	V9Z 1B2	-123.688852	48.361514	1993	1	165	
104.00	Regional Parks	Lady Falls	Sitting Lady Falls	Witty's Lagoon		-123.522595	48.388325	1980			1,057
476.00	Regional Water Supply Saanich Peninsula Water	Neild Road Pumphouse	1170 Neild	Metchosin	V9C 3X5	-123.553778	48.406441	1995	1	156	
258.00	Supply	Martindale Meter Chamber	Martindale Rd./Glidden Rd.,	Central Saanich		-123.394726	48.561487	1975	1	135	

305.10	Peninsula Water Supply	McDonald Park - PRV Station	10299B McDonald Park Rd.	North Saanich	V8L 517	-123.416653	48.661686	1990	1	203
305.20	Peninsula Water Supply	Towner Park - PRV Station	Park Rd.	North Saanich	V8L 5L6	-123.457679	48.667631	1990	1	203
231.00	Saanich Peninsula Water Supply	Dean Park Middle PRV Chamber	8752 Carmanah Terrace,	North Saanich	V8L 5E9	-123.435736	48.619458	1994	1	224
482.00	Regional Water Supply	Townview Pump Station	Townview Terrace	Colwood	V9C 3L9	-123.507331	48.421579	1990	1	200
237.00	Saanich Peninsula Water Supply	Bazan Bay Control Valve Chamber	2030 Bazan Bay Road,	North Saanich	V8L 3X7	-123.415647	48.624636	1996	1	184
257.00	Supply	Mills Road Valve Chamber	Mills Rd/W. Saanich Rd.,	North Saanich		-123.444245	48.655282	1975	1	180
478.00	Regional Water Supply	Glen Forest Way Pumphouse	1093 Glen Forest Way	Metchosin	V9C 3X8	-123.549264	48.398486	1973	1	125
485.00	Regional Water Supply	Bexhill Pumphouse	Bexhill Place & Bexhill Road	Colwood	V9C 3R7	-123.510921	48.423733	1992	1	136
271.00	Saanich Peninsula Water Supply	Veyaness Valve Chamber	6989 Veyaness Road	Central Saanich	V8M 1W1	-123.409965	48.570349	1995	1	238
241.00	Supply	Stelly's P.R.V.	Stelly's Cross Road,	Central Saanich	V8M 1H3	-123.436442	48.579846	1981	1	168
467.00	Regional Water Supply	Ayum Pumphouse	5015B Ayum Rd	Sooke	V0S 1N0	-123.655595	48.398490	1993	1	200
468.00	Regional Water Supply	Ludlow Pumphouse	5013 Ludlow Road	Sooke	V9Z 0E6	-123.657195	48.397613	1998	1	193
469.00	Regional Water Supply	Coppermine Pumphouse #1	Road	East Sooke	V8Z 1B2	-123.679182	48.364278	1977	1	120
239.00	Supply	Keating P.R.V.	Keating Cross Rd.,	Central Saanich	V8M 2A6	-123.403720	48.564991	1981	1	150
491.00	Regional Water Supply	Peacock Pumphouse	2174 Gourman Rd	road right of way (Langford)	V9B 6C3	-123.494330	48.469742	1998	1	112
240.00	Supply	East Saanich P.R.V.	E. Saanich Road,	Central Saanich		-123.419373	48.587981	1982	1	117
473.00	Regional Water Supply	Shaw Pumphouse	nr. 1092 Shaw	Langford	V9B 4H6	-123.511854	48.462043	1975	1	155
474.00	Regional Water Supply	Treanor Pumphouse	719 Treanor	Langford	V9B 3R3	-123.503666	48.464926	1994	1	120
480.00	Regional Water Supply	Stirrup Pump Station/Pneumatic Tank	3984 Stirrup Place	Metchosin	V9C 4A3	-123.533666	48.397030	1992	1	123
520.80	Regional Water Supply	PRV SITE - SUPPLY	Ernest		V8P 1G3	-123.321561	48.449872	1988	1	129
520.90	Regional Water Supply	PRV SITE - SUPPLY	Charters Creek			-123.700292	48.415204		1	127
463.00	Regional Water Supply	Henlyn Pumphouse	Henlyn	Sooke	V9Z 0N5	-123.751225	48.375322	1982	1	175
480.10	Regional Water Supply	Irwin Road Pump Station (Creekside)	2960 Creekside Trail	Langford	n/a	-123.545074	48.443557	2000	1	144
489.00	Regional Water Supply	Deer Park Pump Station (Liberty)	Deer Park Trail/Liberty	Metchosin	V9C 4J5	-123.581536	48.369793	2000	1	150
477.00	Regional Water Supply	Gourman Pumphouse	2168 Gourman Pl.	Langford	V9B 6C3	-123.494730	48.469177	1984	1	100
479.00	Regional Water Supply	Pears Road Pumphouse	826 Pears	Metchosin	n/a	-123.538126	48.390545	1975	1	100
433.00	Regional Water Supply	Generator Building	Sooke Lake Dam	Sooke	n/a	-123.701597	48.516712	1970	1	252
207.00	Disposal	Hartland Road - Weigh Scale Office # 1	Hartland Road, Landfill,	Saanich	V9E 1L7	-123.459589	48.533587	2006	1	250
690.00	Wilderness Mtn Wtr Svc	Wilderness Chlorine Bldg/Pumphouse	706 Cains Way	Sooke	V9Z 1C5	-123.611348	48.357593	1975	1	160
348.00	Magic Lake Estates Sewer System	Cannon Wastewater Treatment Facility	4819 Cannon Crescent,	North Pender Island	V0N 2M2	-123.282455	48.757378	1975	1	484
465.00	Regional Water Supply	PRV Site - Distribution	2158 Maple Ave	Sooke		-123.740455	48.377719	1994	1	150
487.00	Regional Water Supply	Blue Sky Pumphouse	3447 Blue Sky Place	road right of way		-123.511668	48.418890	1989	1	83
617.00	Regional Water Supply	Shoreline Drive Prv Station	Shoreline Drive	View Royal	V9B 1M6	-123.426126	48.452220	2003	1	65
687.00	Regional Water Supply	Bishops Gate PRV Station		Langford		-123.511039	48.474084	2006	1	60
350.50	Magic Lake Estates Water System	Magic Lake RWPS (Raw Water Pump Station)	4720 Buccaneers Road	North Pender Island	V0N 2M2	-123.287327	48.765886			
217.71	SWMP - Solid Waste Disposal	North Leachate Pump Station - Emergency Power Generator	Hartland Road, Landfill,	Saanich	V9E 1L7	-123.461344	48.539692	1993	1	132

349.00	Magic Lake Estates Sewer System	Magic Lake Estates Sewage Booster Station (Galleon)	N.W. of Buck Lake,	North Pender Island	V0N 2M2	-123.282433	48.757363	1965	1	144
683.10	Fulford Water	Fulford Water Treatment Pumphouse	203 Southridge Drive	Salt Spring Island	V8K 1Y9	-123.446149	48.775855	2008	1	180
690.10	Wilderness Mtn Wtr Svc Salt Spring Island - Comm	Wilderness Mountain Pumpstation	706 Cains Way	Sooke	V9Z 1C5	-123.609933	48.358888	1975	1	80
179.10	Parks & Rec	Centennial Park Gazebo	off 2257 Fulford-Ganges Rd.,	Salt Spring Island	V8K 1Z6					
735.00	Regional Water Supply	Survey Mountain Telecommunications Site - Power Systems Container	Survey Mountain	Survey Mountain		-123.799671	48.559670	2010		320
356.50	Magic Lake Estates Sewer System	Chart Drive Pump Station	2615 Chart Drive,	North Pender Island	V0N 2M2	-123.313473	48.776613		1	
610.00	Skana Water (Mayne) Salt Spring Island - Comm	SKANA Water System: well & equipment	491 Waugh Road	Mayne Island	V0N 2J0	-123.288078	48.868361	1970		144
175.40	Parks & Rec	Portlock Park Workshop	145 Vesuvius Bay Rd.,	Salt Spring Island	V8K 1K3				1	
901.00	Emergency Programs	South Island Communications Centre	4219 Commerce Circle	Saanich	V8Z 6N6	-123.392903	48.481032	2019		13,430
946.00		Residual Solids Conveyance Line Pumpstation Chamber 3	Close to 5058 W. Saanich Road	Saanich	V9E 2E7			2020		
945.00		Residual Solids Conveyance Line Pumpstation Chamber 2	Close to 1368 Courtland Ave.	Saanich	V9E 2C5			2020		
947.00		Residual Solids Conveyance Line Pumpstation Chamber 4	280 Willis Point Road	Saanich	V9E 1K1			2020		
903.00	Gulf Island Docks SWMP - Solid Waste	Spanish Hills (Dock, Pier, Structures)	Galiano Island	Galiano Island		-123.584358	48.994742			n/a
932.00	Disposal	New RTF / Commercial Inbound / Outbound Scale Set	Hartland Road, Landfill,	Saanich						
861.00	Regional Parks SWMP - Solid Waste	House - Rental	2548 Sooke River Road	Sooke	V9Z 0X8	-123.704411	48.401799	1990	1	
933.00	Disposal	New Scale Building - RTF and Commercial Lot A District Lot 2&8 Cowichan Plan	Hartland Road, Landfill,	Saanich					1	
843.00	Galiano Parks & Rec	VIP15952 Portion - Dwelling, shop, sheds,	720-1 Active Pass Drive	Galiano Island Elk/Beaver Lake,	V0N 1P0	-123.350669	48.866533	various		various
36.10	Regional Parks	Washroom - Beaver Beach (New)	Elk Lake Drive, Saanich	Saanich Elk/Beaver Lake,	V8Y 2T6	-123.389672	48.509498	2019	1	640
39.10	Regional Parks	Washroom - Filter Beds (New)	Beaver Lake Road, Saanich	Saanich	V8Z 6K2	-123.394368	48.507977	2019	1	640
904.00	Gulf Island Docks SEAPARC - Facilities &	Horton Bay (Dock, Pier, Structures)	Mayne Island	Mayne Island		-123.244546	48.824843			n/a
863.00	Recreation	Sooke Golf Course - Single Family Dwelling	6518 Throup Road	Sooke	V9Z 0W6	-123.714387	48.386388		1	
519.00	Regional Water Supply	Hydro Meteorological - FWI Stations (7) (31N, 14G, NorthBasin, Chris Creek, Martin's Gulch, 4RW) Hydro Meteorological	build & contents	Various	n/a	-123.700589	48.516035	1992		n/a
32.10	Regional Parks	Washroom - Eagle Beach (New)	Pat Bay Highway, Saanich	Elk/Beaver Lake, Saanich	V8Y 2T6	-123.387895	48.524544	2019	1	450
900.20	Regional Water Supply	Bear Mountain Parkway Lower Pressure Control Station (PCS)	Bear Mountain Parkway	Langford				2018		
900.00	Regional Water Supply	Bear Mountain Parkway Upper Pressure Control Station (PCS)	Bear Mountain Parkway	Langford				2018		
900.10	Regional Water Supply	Bear Mountain Parkway Middle Pressure Control Station (PCS)	Bear Mountain Parkway	Langford				2018		

913.00	Salt Spring Island - Comm Parks & Rec SWMP - Solid Waste Disposal	Lions Commemorative Bike Park (Mouats Park)	end of Seaview Rd.	Salt Spring Island	V8K 2V8	-123.504874	48.851719				n/a
934.00	Disposal	Office Trailers by Scales	Hartland Road, Landfill,	Saanich							
422.00	Regional Water Supply	House - Rental	741 Haliburton Road,	Saanich	V8Y 1H7	-123.379984	48.513246		1		
806.10	Regional Parks	Jordan River Campground Earthquake and Tsunami Warning System	Westcoast Road (Jordan River Campground)	Jordan River	V8Z 1L1	-124.054954	48.421236	2016			n/a
841.00	Regional Water Supply	Systems	Healey Mtn	Sooke		-123.737222	48.542363	2014			160
898.00	JDF EA - Community Parks	Port Renfrew Community Trail - Structures		Port Renfrew		n/a	n/a	n/a			n/a
177.00	Salt Spring Island - Comm Parks & Rec	Fulford Ball Park	2260 Fulford-Ganges Rd.,	Salt Spring Island	V8K 1Z6	-123.471449	48.776035	1975			
888.00	Surfside Park Estates (Mayne) SWMP - Solid Waste Disposal	Surfside Reservoir	Mayne Island	Mayne Island	V0N 2J0						n/a
215.00	Disposal	Hartland Operations Workshop #1	Hartland Road, Landfill,	Saanich	V9E 1L7	-123.458976	48.534635	1985	1		1680
644.10	Saturna Island Comm. Parks	Thomson Park - Picnic shelter	Thomson Park	Saturna Island	V0N 2Y0	-123.199436	48.776165				
178.00	Salt Spring Island - Comm Parks & Rec	Fulford Tennis Court	2257 Fulford-Ganges Rd.,	Salt Spring Island	n/a	-123.474476	48.773807	n/a			
914.00	Salt Spring Island - Comm Parks & Rec	Peck's Cove Park - Boardwalk	Lower Ganges Road	Salt Spring Island							n/a
49.00	Regional Parks	Francis/King - Forester's Cabin	1710 Munn Road	Francis/King	V9E 1H7	-123.444549	48.484077	1997 - 1999	1		450
129.00	Willis Point Fire Protect & Recreation	Willis Point George Pears Memorial Park (350)	6933 Willis Point Rd., Prov. Territory	Willis Point	V9E 2A1	-123.480539	48.570905				
133.50	Shirley Fire Protection	Tank	End of Sheringham Pt. Road	Shirley		-123.916419	48.380002				n/a
267.00	Saanich Peninsula Water Supply	Airport PRV & Line Valve Chamber	9500 Willingdon Road,	North Saanich	V8L 5V6	-123.436849	48.641044		1		
294.00	Saturna Island Water System (Lyll Harbour)	L.H./B.C. Money Recirculation Tank	Saturna Island	Saturna Island	V0N 2Y0	-123.183685	48.791748				
363.00	Peninsula Wastewater TP	Boundary Flume Chamber	8460 Central Saanich Road	Central Saanich	V8M 1T7	-123.404081	48.610968		1		
724.00	Regional Water Supply	Supply Shop	Goldstream Pipe Yard	Niagara Main		-123.565081	48.459545		1		
722.00	Beddis Water	Lautman Reservoir	151 Lautman Dr (ROW)	Salt Spring Island	V8K 2C2	-123.463670	48.817964				
44.10	Regional Parks	Parking Lot	Hartland	Mount Work		-123.458774	48.533994		1		
725.00	Magic Lake Estates Water System	Signal Hill PRV - MLE		North Pender Island		-123.300169	48.770779		1		
793.00	Regional Parks	Beaver Lake Dam 1	Beaver Lake	Elk/Beaver Lake		-123.3935	48.5079				380 1 7
793.10	Regional Parks	Concrete Control Dam, Spillway and Fishway	Off Beaver Lake Road at Filter Beds - Colquitz River Outflow	Elk/Beaver Lake				2014			
794.00	Regional Parks	Beaver Lake Dam 2 & 3 (Saddle Dams)	Beaver Lake	Elk/Beaver Lake		-123.3937 / -123.3939	48.5098 / 48.5109	1900			180110; 35818
795.00	Regional Parks	Cabin Pond Dam 1 & 2	Goldstream	Langford		-123.6096 / -123.6104	48.4707 / 48.4707	1900			300112; 420110
796.00	Regional Parks	Jack Lake (and Mavis Lake) Dams	Jack and Mavis Lake	JDF Electoral Area		-123.6330	48.4731				n/a
797.00	Regional Parks	Durrance Lake Dam	Durrance Lake	Durrance Lake		-123.4726	48.5466	1940/1987			194/12
798.00	Regional Parks	Humpback Dam	Humpback Road	Langford		-123.5551	48.4482	1913/1999			53515
799.00	Regional Parks	Charters River Dam	Charters River	Sooke		-123.6974	48.4158	1976			10013
800.00	Regional Parks	Matheson Lake Dam	Matheson Lake	Sooke							n/a
801.00	Regional Parks	Thetis Lake Dams (Lower North Dam / Lower South Dam & Weir / Upper Saddle Dam)	Thetis Lake	Thetis Lake		-123.4683 / -123.4717	48.4648 / 48.4714				12018; 122110; 1751155
						-123.4754	48.4743	1920			

819.00	Regional Water Supply	Sooke Lake Dam compacted earth, reinforced concrete	Sooke Lake	Sooke Lake	-123.7015	48.5171	1970 / 2002	1,749,128
820.00	Regional Water Supply	Saddle Dam (southend Deception) compacted earth, clay core, reinforced	Sooke Lake	Sooke Lake	-123.7069	48.5258	1979 / 1981	1,509,123
821.00	Regional Water Supply	Saddle Dam compacted earth, dam, gate, wells and control house, concrete conduit	Sooke Lake	On Deception &Sooke reservoirs	-123.7079	48.514	1970 / 2002	3,543,132
823.00	Regional Water Supply	Goldstream lake Dam compacted earth, reinforced concrete	Goldstream Lake	JDF Electoral Area	-123.6191	48.4982	1895 / 1995	990122
824.00	Regional Water Supply	Lubbe No. 1 Dam (compacted earth: dam, spillway, high & low level outlets, sluice	Lubbe Lake	JDF Electoral Area	-123.6235	48.5165	1895 / 1995	144116
824.10	Regional Water Supply	Lubbe No. 2 Dam (compacted earth, riprapi, concrete median barrier and bedding)	Lubbe Lake	JDF Electoral Area	-123.6126	48.5279	1895 / 1995	82116
824.20	Regional Water Supply	Lubbe No. 3 Dam (compacted earth, riprapi, concrete median barrier and bedding)	Lubbe Lake	JDF Electoral Area	-123.6120	48.5281	1895 / 1995	121116
824.30	Regional Water Supply	Lubbe No. 4 Dam (compacted earth, riprapi, concrete median barrier and bedding)	Lubbe Lake	JDF Electoral Area	-123.6111	48.5286	1895 / 1995	98116
825.00	Regional Water Supply	Butchart No. 1 Dam(compacted earth: dam, spillway, high & low levels outlets, sluice	Butchart Lake	JDF Electoral Area	-123.6264	48.5293	1895 / 1995	300116
825.10	Regional Water Supply	Butchart No. 2 Dam (compacted earth, piezometer tubes, riprapi, concrete blocks inter-locking stackable	Butchart Lake	JDF Electoral Area	-123.6249	48.5309	1895 / 1995	180120
825.20	Regional Water Supply	Butchart No. 3 Dam (compacted earth, loose boulders)	Butchart Lake	JDF Electoral Area	-123.6500	48.5469	1900	57114
825.30	Regional Water Supply	Butchart No. 4 Dam (compacted earth, riprapi, wooden debris boom)	Butchart Lake	JDF Electoral Area	-123.6514	48.5467	1900	159114
825.40	Regional Water Supply	Butchart No. 5 Dam (compacted earth, riprapi, concrete median barrier and bedding, wooden debris boom)	Butchart Lake	JDF Electoral Area	-123.6549	48.5469	1895 / 1995	515112
826.00	Regional Water Supply	Japan Gulch Reservoir Dam (compacted earth, reinforced concrete)	Sooke Lake	Sooke	-123.5809	48.4639	1895 / 1995	314120
827.00	Regional Water Supply	Wilfred No. 1 Dam North (reinforced concrete: concrete gravity structure, metal	Wilderness Mountain	Wilderness Mountain	-123.6125	48.3594	1999	6612
827.10	Regional Water Supply	Wilfred No. 2 Dam South (reinforced concrete, concrete gravity structure, metal	Wilderness Mountain	Wilderness Mountain	-123.6124	48.3574	1999	4312
828.00	Regional Water Supply	Magic Lake Dam (South and North)	Magic Lake	North Pender Island	-123.2789 / -123.2909	48.7588 / 48.7643	?/1984	23319.8

Building Construction	Roof - Construction	Roof - Final Surface	No. of Stories (Above Ground)	No. of Stories (incl. basements and parking)	PROTECTION			Occupancy Type
					Sprinklers	Burglar	Fire Protection (Pr) Hydrants	
structural frame								
concrete	concrete	membrane, gravel & green roof	4	5	yes	yes	zoned fire alarm system, pull & bell alarm, extinguishers, emergency lighting	office
concrete & steel	steel	metal & membrane	2	3	no	yes	fire alarm panel	treatment plant
								community recreation centre, including ice arena, aquatic centre, racquet sports courts, fitness areas & administration
steel	metal	metal & built up composition	2	3	yes	yes	zoned fire alarm system, pull & bell alarm, fire extinguishers, emergency lighting	
concrete & steel	concrete	built up composition, modified bitumen	3	4	yes	yes	smoke detectors	theatre
masonry & steel	steel	metal panel, modified bitumen	2	2	yes	yes	yes	recreation centre
steel	steel & metal	membrane double ply & asphalt	2	2	yes	yes	Stand pipe, manual pull stations, exit & emergency lights lighting, extinguishers	governmental medical building
concrete				1	no	no	no	underground open reservoir
masonry & steel	steel & wood	membrane	2	2	no	yes	pull station, emergency lights	school
steel & wood	steel & wood	metal	1	2	yes	yes	extinguishers	community centre
steel	wood frame	metal & torch on with gravel	2	2	no	yes	zoned fire alarm system, pull & bell alarm, emergency lighting	medical offices
wood & steel	wood frame	metal & membrane	2	2	no	no	alarm system, pulls, gongs & fire extinguishers	offices, shops, warehouse & garage
concrete	concrete	concrete		1	no	yes	no	reservoir
concrete	concrete	concrete		1	no	yes	no	reservoir
steel & wood	wood	membrane double ply & gravel	2	3	yes	yes	zoned fire alarm system, pull & bell alarm, extinguishers, emergency lighting	public library
concrete	concrete	concrete	1	1	no	yes	no	water reservoir
masonry	steel	metal	1	2	yes	yes	yes	water UV disinfection plant
steel	metal	metal	1	1	yes	yes	extinguishers, emergency lighting	ice arena
masonry	wood frame	built up composition	1	2	no	yes	pull & bell alarm, extinguishers, emergency lighting	governmental medical building
n/a	n/a	n/a			no	no	no	power plant
concrete	steel & metal	membrane double ply & gravel	2	2	yes	yes	zoned fire alarm system, pull & bell alarm, emergency lighting	governmental medical building
various	various	various	1	1	no	no	no	secondary wastewater treatment plant
steel	n/a	n/a	n/a	n/a	no	no	no	pedestrian bridge
concrete	concrete	membrane	2	2	no	yes	fire extinguisher	sewage pump station
concrete	concrete	concrete	1	1	no	yes	no	reservoir
concrete	concrete	n/a	1	1	no	yes	yes	reservoir / pump station
concrete	concrete	concrete		1	no	yes	no	water reservoir
concrete	concrete	concrete	1	1	no	yes	no	reservoir
concrete	glulam	concrete			no	no	emergency lighting	wastewater pump station

concrete	concrete	concrete		1	no	yes	fire extinguishers	sewage storage tank
steel	steel	steel	1	1	no	yes	no	reservoir
concrete	concrete	concrete	1	1	no	yes	fire extinguisher	water reservoir
concrete	concrete	concrete	1	1	no	yes	no	water reservoir
concrete	concrete	concrete	1	1	no	yes	no	water reservoir
masonry	concrete & steel	concrete	1	2	no	yes	yes	head tank
masonry	concrete	n/a	2	2	no	yes	yes	water screening tower
concrete	concrete	membrane	2	2	no	yes	fire extinguishers	outfall pump station
concrete	concrete	membrane	2	2	no	yes	fire extinguishers	outfall pump station
concrete	concrete	concrete	1	1	no	yes	no	water reservoir
masonry & steel	steel	built up composition	1	2	no	no	smoke detectors	water treatment plant
masonry & concrete	concrete	membrane & wood shakes	2	3	no	yes	fire extinguishers	sewage pump station
concrete	concrete	concrete		1	no	yes	no	water reservoir
steel	steel	metal	2	2	yes	yes	emergency lights, extinguishers, annunciator, pull station	volunteer fire hall
clay core					no	no	no	dam
concrete	concrete	concrete	1	1	no	yes	no	reservoir
wood	n/a	n/a	n/a	n/a	no	no	no	pedestrian bridge
wood & steel					no	no	no	pier, ramps, piling, floats
concrete	concrete & wood	modified bitumen membrane	3	3	partial	yes	smoke detectors, pull & bell alarm, fire extinguishers	office & storage
concrete	wood frame	2-ply reinforced membrane	1 + partial 2	1 + partial 2	no	no	smoke detectors	fire hall
masonry	steel	composition shingles	1	2	yes	yes	standpipe & detector	water disinfection plant
concrete	concrete	built up composition		1	no	yes	fire extinguishers	sewage pump station, odour & electric control
n/a	n/a	n/a	n/a	n/a	no	no	no	waste drop-off centre
concrete	concrete	concrete	1	1	no	yes	n/a	reservoir
wood	wood frame	metal	1	1	no	no	smoke detectors, fire extinguishers & emergency lighting	office
wood	n/a	n/a	n/a	n/a	no	no	no	pedestrian bridge
concrete	concrete	concrete	1	1	no	yes	no	reservoir
steel	n/a	n/a	n/a	n/a	no	no	no	pedestrian bridge
wood	wood frame	metal	2	2	no	yes	yes	volunteer fire hall
concrete	concrete	concrete	1	1	no	yes	no	reservoir

wood	wood frame	midified bitumen membrane	1	1	no	no	smoke detectors, fire extinguishers	office
concrete & wood	wood frame	corrugated metal, modified bitumen	2	2	no	no	smoke detectors, pull & bell alarm, fire extinguishers & emergency lighting	fire hall
masonry	n/a	n/a	1	1	no	no	fire extinguishers	pump station & valve chamber
steel	steel	steel			no	no	no	live fire training facility
wood	wood frame	enameled corrugated metal panel	2	2	no	yes	smoke detectors, fire extinguishers & emergency lighting	office
concrete	concrete	concrete		1	no	yes	yes	PRV valve station
concrete	concrete	concrete	1	1	no	yes	no	reservoir
wood	wood frame	metal	1	1	no	no	smoke detectors, gong and fire extinguishers	public library, community hall
wood	wood frame	enameled corrugated metal panel	2	2	no	yes	smoke detectors, fire extinguishers & emergency lighting	office & storage
wood	wood frame	corrugated metal	1	2	no	no	smoke detectors, pull & bell alarm, fire extinguishers & emergency lighting	mixed-use fire hall & community hall
steel	n/a	n/a			no	yes	no	wastewater treatment plant
concrete	n/a	n/a	n/a	n/a	no	no	no	skate park
wood	wood frame	enameled corrugated metal panel	2	2	no	yes	smoke detectors, fire extinguishers	offices, shop & garage
wood & steel					no	no	no	pier, ramps, piling, floats
concrete	concrete	concrete	1	1	no	yes	no	reservoir
wood	wood frame	composition	1	1	no	no	smoke detectors, gong & fire extinguishers	library, community hall & info centre
steel & wood	wood & steel	metal panel	1	1	no	no	smoke detectors	fire hall
wood & steel	n/a	n/a			no	no	no	pier, ramps, piling, floats
concrete	concrete		1	1	no	yes	no	reservoir
concrete	concrete	concrete	1	1	no	yes	no	water reservoir
wood & steel	n/a	n/a			no	no	no	pier, ramps, piling, floats
steel	n/a	n/a			no	no	n/a	radio tower
masonry & steel	steel	metal	2	2	no	yes	yes	water screening tower
masonry	wood frame	built up composition	1	1	no	yes	pull & bell alarms, fire extinguishers & emergency lighting	administration offices
wood	wood frame	corrugated metal	1	1	no	no	smoke detectors, pull & bell alarm, fire extinguishers & emergency lighting	fire hall
concrete	concrete	concrete	1	1	no	yes	no	reservoir
steel	steel	metal	1	1	no	no	smoke detectors	volunteer fire hall
concrete	concrete	n/a	1	1	no	yes	no	reservoir
wood & steel	n/a	n/a			no	no	no	pier, ramps, piling, floats
wood	wood frame	metal	1	1	no	no	smoke detectors, pull & bell alarm & fire extinguishers	fire hall
wood	wood frame	corrugated metal panel	2	2	no	no	smoke detectors, fire extinguishers	single-family residence & offices
wood & masonry	wood frame	metal	1	2	no	no	fire extinguishers	public library

wood	wood frame	asphalt shingles	1	1	no	yes	no	wastewater treatment plant
wood & steel					no	no	no	pier, ramps, piling, floats
wood	wood	metal	1	2	no	no	fire extinguishers	water treatment equipment & booster pumps
prefab steel and foam panel	steel	steel			yes	yes	sprinklers, fire alarm system, extinguishers, pull stations, detectors, lights and illuminated exit signs	water treatment
steel	n/a	n/a	n/a	n/a	no	no	no	pedestrian bridge
clay core					no	no	no	dam
n/a	n/a	n/a	n/a	n/a	no	no	no	park & boardwalk
masonry & concrete	concrete	built up composition	1	1	no	yes	extinguishers	sewage pump station, odour & electric control
concrete	n/a	n/a	n/a	n/a	no	no	no	skate park
concrete				1	no	yes	no	sewer pump station
wood & steel	n/a				no	no	no	pier, ramps, piling, floats
steel	n/a	n/a	n/a	n/a	no	no	no	pedestrian bridge
steel	steel	metal	1	1	no	no	fire extinguishers	workshop
wood & steel	wood	asphalt shingles	1	1	no	no	fire extinguishers	recycling drop-off
steel	steel frame	metal crimped panel	1	1	no	no	smoke detectors & fire extinguishers, alarms	fire hall
concrete	concrete		1	1	no	yes	no	reservoir
					no	no	no	recreation
various	n/a	n/a			no	no	no	pier, ramps, piling, floats
concrete & steel					no	no	no	public washrooms & change rooms, storage
masonry	wood frame	wood shingles, corrugated metal	1	1	no	no	no	sewer pump station
concrete	metal	metal		1	no	yes	no	
n/a	n/a	n/a	n/a	n/a	no	no	no	boardwalk
concrete	concrete	concrete	1	1	no	yes	fire extinguisher	water pump station
wood	wood frame	asphalt shingles	1	1	yes	yes	fire alarm	office
masonry & concrete	steel	metal & membrane	1	2	no	yes	fire extinguishers	sewage booster pump station
wood	wood frame	composition shingles	1	2	no	no	smoke detectors & fire extinguishers	single-family residence
steel					no	yes	no	radio tower
wood	wood	asphalt shingles	1	1	no	yes	no	water treat equipment
n/a	n/a	n/a	n/a	n/a	no	no	no	baseball diamond
masonry	wood frame	modified bitumen membrane	1	1	no	no	fire exitinguishers	public washrooms & change rooms
prefab steel and foam panel	steel	steel			yes	yes	sprinklers, fire alarm system, extinguishers, pull stations, detectors, lights and illuminated exit signs	water treatment

wood	wood frame	metal	1	1	no	no		no	public washroom
concrete & metal	n/a	n/a		1	no	yes		no	sewer lift pump station
wood	wood frame	corrugated metal panel	2	2	no	yes		smoke detectors & fire extinguishers	office & storage
steel	n/a	n/a		1	no	yes		no	reservoir & valve chamber
wood	wood	asphalt shingles	1	1	no	no		smoke detectors, pull & bell alarm, fire extinguishers & emergency lighting	presentation centre
wood	wood frame	asphalt shingles	1	2	no	yes		yes	caretaker house & office
masonry	steel	built up composition	1	1	no	yes		fire extinguishers	water pump station
concrete	concrete	membrane		1	no	yes		fire extinguisher	underground sewage pump station
wood	wood frame	metal panel	1	1	no	no		smoke detectors	fire hall
wood	wood frame	metal	1	1	no	no		fire extinguishers	administration offices
concrete and steel	n/a	n/a			no	no	n/a	no	pedestrian bridge
wood	wood frame	metal	1	1	no	yes		no	water treatment equipment
steel	n/a	n/a			no	yes	n/a	no	radio tower
wood	n/a	n/a	n/a	n/a	no	no		no	recreational loop trail
steel	steel	metal	1	1	no	yes		yes	FOC storage
steel					no	no		no	pedestrian bridge
stud frame	wood	composition shingles	1	1	no	no		yes	fire pump station
wood & steel					no	no		no	pier, ramps, piling, floats
manufactured	manufactured	EPDM	1	1	no	yes		yes	office
concrete				1	no	yes		no	sewer lift pump station
n/a	n/a	n/a	n/a	n/a	no	no	n/a	no	scale
steel	steel	steel	1	1	no	yes		no	reservoir
pre-engineered	pre-engineered	pre-engineered	1	1	no	no		fire extinguisher	radio equipment
steel	n/a	n/a		1	no	yes		no	reservoir
wood & steel	n/a	n/a			no	no		no	pier, ramps, piling, floats
wood	wood frame	asphalt shingles	1	1	no	yes		smoke detectors, fire extinguishers	storage & workshop
wood & steel					no	no		no	pier, ramps, piling, floats
masonry	wood	rubber shingles	1	1	no	no		yes	water pump station
wood	n/a	n/a			no	no	n/a	no	boardwalk
masonry	wood frame	rubber shingles	1	1	no	yes		yes	water pump station
various	n/a	n/a			no	no	n/a	no	park & boardwalk
masonry	wood frame	modified bitumen membrane	1	1	no	no		emergency lighting, fire extinguishers	storage & general office
wood	wood frame	enameled corrugated metal panel	1	1	no	no		smoke detectors, fire extinguishers	display & storage
concrete	n/a	n/a	n/a	n/a	no	no		no	vehicle bridge

metal	n/a	n/a	1	1	no	no	no	no	biosolids storage
wood	n/a	n/a	n/a	n/a	no	no	no	no	pedestrian bridge
wood	n/a	n/a	n/a	n/a	no	no	no	no	pedestrian bridge
n/a	n/a	n/a	n/a	n/a	no	no	n/a	no	scale
masonry & concrete	concrete	built up composition		1	no	yes		fire extinguishers	sewage pump station & odour control
concrete	concrete	concrete		1	no	yes		no	sewer lift pump station
steel	steel frame	corrugated metal	1	1	no	no		pull & bell alarm, fire extinguishers & emergency lighting	garage
wood	wood frame	modified bitumen membrane	1	1	no	no		pull & bell alarm, fire extinguishers & emergency lighting	office
concrete					no	no		no	skate park
wood	wood frame	metal	1	1	no	yes		no	wastewater treatment plant
wood	wood frame	metal	1	1	no	no		smoke detector, fire extinguisher	office
concrete				1	no	yes		no	sewerlift pump station
steel			1	1	no	yes		no	reservoir
concrete	concrete	concrete		2	no	yes		fire extinguisher	underground water pump station
wood	wood	metal	1	1	no	yes		no	mobile equipment & general storage
wood	wood	metal			no	yes		no	well house
wood	wood	asphalt shingles	1	1	no	no		smoke detectors & fire extinguishers	equipment workshop
masonry	concrete	membrane	1	1	no	yes		no	thermal recover facility
masonry	wood	rubber shingles	1	1	no	yes		yes	water pump station
wood	wood	torch on	1	1	no	yes		no	water treatment
masonry	wood	rubber shingles	1	1	no	yes		yes	water pump station
wood	wood frame	metal	1	2	no	no		smoke detector, fire extinguisher	single family residence
wood	wood frame	asphalt shingles	1	1	no	no		fire extinguishers	park cookhouse & shelter
fibreglass				1	no	yes		no	sewer lift pump station
steel			1	1	no	yes		no	reservoir
fibreglass				1	no	yes		no	sewer lift pump station
steel	n/a	n/a	n/a	n/a	no	no		no	pedestrian bridge
fibreglass				1	no	yes		no	sewer lift pump station
fibreglass				1	no	yes		no	sewer lift pump station
masonry and concrete	lift slab				no	yes		fire extinguishers	equipment
fibreglass				1	no	yes		no	sewer lift pump station

masonry	wood frame	metal	1	1	no	yes		fire extinguishers	on-site chlorination & fire pump
wood	n/a	n/a	n/a	n/a	no	no		no	fishing pier
					no	yes		no	sewage pump station
steel			1	1	no	yes		no	reservoir & valve chamber
concrete	concrete	concrete		1	no	no		no	underground valve chamber
wood	wood frame	metal	1	1	no	yes		fire extinguishers	water treatment plant & booster pumps
wood	wood	asphalt shingles			no	yes		no	well and pumphouse
steel	n/a	n/a	1	1	no	yes	n/a	no	reservoir
concrete	concrete	concrete	1	1	no	yes		fire extinguishers	pressure reduction valve
metal	metal	metal	1	1	no	yes		no	thermal recover facility
wood	wood frame	metal	1	1	no	yes		no	water well house
masonry	wood	rubber shingles	1	1	no	yes		yes	water pump station
steel	n/a	n/a			no	no	hydrant	no	water tank
					no	yes		no	well
steel	steel	metal	1	1	no	yes		yes	boat house
concrete	concrete	concrete		1	no	yes		fire extinguisher	underground water pump station
fibreglass and concrete	n/a	n/a			no	no		fire extinguishers	pump station and valve chamber
masonry	wood	rubber shingles	1	1	no	yes		yes	water pump station
wood	wood frame	composition shingles	1	1	no	no		no	single-family residence
wood	wood frame	metal	1	1	no	no		no	workshop
wood	wood frame	asphalt shingles	1	1	no	yes		no	wastewater treatment plant
fibreglass				1	no	yes		no	sewer lift pump station
					no	yes		no	sewage pump station
steel	n/a	n/a			no	no	n/a	no	pedestrian bridge
wood	wood	asphalt shingles	1	1	no	yes		no	water treatment
wood	wood joists and wood deck	metal	no	no	no	no		extinguishers	storage
concrete	concrete	concrete	1	1	no	yes		fire extinguishers	water pump station
wood	n/a	n/a	n/a	n/a	no	no		no	pedestrian bridge
masonry	concrete	concrete		1	no	yes		yes	PRV station
concrete	concrete	concrete		1	no	yes		fire extinguishers	water pump station
steel			1	1	no	yes		no	reservoir
					no	no		no	park shelter

wood	wood frame	metal	1	1	no	yes		no	water treatment & well pump house
wood	wood	asphalt shingles	1	1	no	yes		no	reservoir & pumphouse
steel	wood frame	asphalt shingles	1	1	no	yes		no	water pumps
steel	steel	steel	1	1	no	yes	n/a	no	reservoir
wood	wood	metal	1	1	no	yes	n/a	no	water well houses
prefab modular on reinforced concrete					no	no		fire extinguishers	workshop
concrete	concrete	concrete		1	no	yes		fire extinguishers	underground water pump station
steel	steel	steel			no	no	n/a	no	reservoir
masonry	concrete	built up composition	1	1	no	yes		yes	domestic & fire pump station
masonry	concrete	concrete		1	no	yes		yes	underground PRV station
concrete	concrete	concrete		1	no	yes		fire extinguishers	PRV & pump station
n/a	n/a	n/a	n/a	n/a	no	no		no	public pathway
masonry	concrete	built-up composition	1	1	no	yes		yes	UV disinfection & pump station
masonry	concrete	concrete		1	no	yes		yes	water pump station
steel			1	1	no	yes		no	reservoir
masonry	concrete	built up composition	1	1	no	yes		fire alarm	ammonia building
					no	no		no	park shelter
masonry	concrete	concrete		1	no	yes		yes	underground PRV station
masonry	concrete	concrete	1	1	no	yes		yes	underground PRV station
masonry	wood	rubber shingles	1	1	no	yes		yes	water pump station
wood	wood frame	built up composition	1	1	no	yes		fire extinguishers	water treatment plant & booster pumps
concrete	concrete	concrete	1	1	no	yes		fire extinguisher	water flow meter & valves chamber
masonry	concrete	concrete		1	no	yes		yes	underground PRV station
concrete	concrete	concrete		1	no	yes		no	flow meter & valves chamber
wod	wood	torch-on	1	1	no	yes		no	water booster pump station
masonry	concrete	built up composition	1	1	no	yes		yes	fire pump station
masonry	concrete	built up composition	1	1	no	yes		yes	domestic & fire pump station
wood	wood frame	asphalt shingles	1	1	no	yes		no	water treatment plant
masonry	n/a	n/a	1	1	no	yes	yes	fire extinguishers	scale building
masonry	concrete	concrete		1	no	yes		yes	underground water pump station
concrete	concrete	concrete		1	no	yes		fire extinguishers	pressure reduction valve
masonry	concrete	n/a	1	1	no	yes		yes	water pump station
wood	n/a	n/a	n/a	n/a	no	no		no	recreational observation decks
masonry	concrete	n/a	1	1	no	yes		yes	water pump station
concrete	concrete	concrete		1	no	yes		no	meter chamber

concrete	concrete	concrete		1	no	yes		no	pressure reduction valve
concrete	concrete	concrete		1	no	yes		no	pressure reduction valve
concrete	concrete	concrete		1	no	yes		fire extinguisher	PRV chamber
masonry	concrete	built up composition	1	1	no	no		yes	water pump station
concrete	concrete	concrete	1	1	no	yes		no	pressure reduction valve
concrete	concrete	concrete		1	no	yes		no	control valve chamber
masonry	concrete	concrete		1	no	yes		yes	water pump station
masonry	concrete	n/a	1	1	no	yes		yes	water pump station
concrete	concrete	concrete		1	no	yes		no	valve chamber
concrete	concrete	concrete		1	no	yes		no	pressure reduction equipment
masonry	concrete	built up composition	1	1	no	yes		yes	water pump station
masonry	concrete	built up composition	1	1	no	yes		yes	fire pump station
masonry	concrete	built up composition	1	2	no	yes		yes	water pump station
concrete	concrete	concrete	1	1	no	yes		no	pressure reduction equipment
masonry	concrete	concrete		1	no	no		yes	underground water pump station
concrete	concrete	concrete		1	no	yes		no	valve chamber
masonry	concrete	built up composition	1	1	no	yes		yes	water pump station
masonry	concrete	n/a	1	1	no	yes		yes	water pump station
masonry	concrete	n/a	1	1	no	yes		yes	water pump station
masonry	concrete	concrete		1	no	yes		yes	underground PRV station
masonry	concrete	concrete		1	no	yes		yes	underground PRV station
masonry	concrete	built up composition	1	2	no	no		yes	water pump station
masonry	concrete	built up composition	1	1	no	yes		yes	water pump station
masonry	concrete	n/a	1	1	no	yes		yes	water pump station
masonry	concrete	concrete		1	no	yes		yes	water pump station
masonry	concrete	concrete		1	no	yes		yes	water pump station
masonry	concrete	built up composition	1	1	no	no		fire alarm	generator building
mobile office	n/a	n/a	1	1	no	yes	yes	fire extinguishers	scale building
steel	steel	n/a	1	1	no	yes		yes	chlorination plant
steel & wood	wood frame	metal	1	1	no	yes		no	wastewater treatment plant
masonry	concrete	built up composition	1	1	no	yes		yes	PRV site distribution
masonry	concrete	concrete		1	no	yes		yes	water pump station
masonry	concrete	concrete		1	no	yes		yes	underground PRV station
masonry	concrete	concrete		1	no	yes		yes	underground PRV station
concrete	concrete	concrete			no	yes		no	pump station
masonry and concrete blocks	concrete				no	no		fire extinguishers	pump station generator

wood	wood frame	asphalt shingles	1	1	no	yes	no	water booster pump & PRV station
wood	wood	asphalt shingles	1	1	no	yes	no	water booster pump station
masonry	concrete	built-up composition	1	1	no	yes	yes	water pump station
					no	no	no	park shelter
steel	steel	steel	1	1	no	no	fire extinguisher	solar/wind power system, radio & geospatial equipment
concrete	concrete	concrete			no	yes	no	pump station
wood	wood frame	metal	1	1	no	yes	no	water well house
					no	no	fire extinguishers	workshop
concrete	concrete	membrane			yes	yes	no	office
concrete	concrete	concrete			no	yes	no	pumpstation
concrete	concrete	concrete			no	yes	no	pumpstation
concrete	concrete	concrete			no	yes	no	pumpstation
wood & steel	n/a	n/a			no	no	no	pier, ramps, piling, floats
			2	3	no	no	no	scales
					no	no	no	dwelling
					no	yes	yes	office
various	various	various			no	no	no	various
concrete block	wood frame	metal			no	no	no	washroom
concrete block	wood frame	metal			no	no	no	washroom
concrete & steel	n/a	n/a			no	no	n/a	pier, ramps, piling, floats
wood	wood frame	asphalt shingles			no	no	no	dwelling
					no	no	no	hydro meteorological station
concrete block	wood frame	metal			no	no	no	washroom
concrete	concrete	concrete			no	yes	no	pressure control station
concrete	concrete	concrete			no	yes	no	pressure control station
concrete	concrete	concrete			no	yes	no	pressure control station

n/a	n/a	n/a			no	no	n/a	no	bike park
wood	wood frame	asphalt shingles			partial	yes		fire extinguishers	office dwelling
steel shipping container	steel	steel	n/a	n/a	no	no	n/a	no	system radio equipment
n/a	n/a	n/a	n/a	n/a	no	no	n/a	no	trail
					no	no		no	recreation
concrete	concrete	concrete			no	yes	n/a	no	reservoir
steel	steel	steel			no	yes		fire extinguishers	workshop
wood	wood				no	no			park shelter
n/a	n/a	n/a	n/a	n/a	no	no	n/a	no	recreation
wood	n/a	n/a			no	no		no	boardwalk
wood	wood frame	metal			no	no		no	office
					no	no		no	park
steel	steel	steel			no	no		no	water tank
concrete	concrete	concrete		1	no	yes		no	valve chamber
					no	yes		no	tank
concrete	concrete	concrete			no	yes		no	flume chamber
					no	no		no	storage
					no	yes		no	reservoir
					no	no		no	washroom
compacted earth					no	yes		no	pvr station
								n/a	water retention dam
compacted earth								n/a	water retention dam
compacted earth								n/a	water retention dam
n/a								n/a	n/a
compacted earth								n/a	water retention dam
reinforced concrete								n/a	water retention dam
reinforced concrete								n/a	water retention dam
n/a								n/a	water retention dam
compacted earth								n/a	n/a
compacted earth								n/a	water retention dam, trail component

compacted earth	water retention dam
compacted earth	water retention dam
compacted earth	water retention dam
compacted earth	water retention dam
compacted earth	water retention dam
compacted earth	water retention dam
compacted earth	water retention dam
compacted earth	water retention dam
compacted earth	water retention dam
compacted earth	water retention dam
compacted earth	water retention dam
compacted earth	water retention dam
clay core	water retention dam
clay core, concrete	water retention dam
concrete	water retention dam
concrete	water retention dam
clay core	water retention dam

NAME OF FACILITY	ADDRESS	LOCATION	TENURE	BCAA PID/PIN Number	Jurisdictional Roll Number	Estimated Postal Code	LONGITUDE	LATITUDE	Build Date / Renos	Seismic Upgrade	Building Structure	Size of Building (square ft)	Dimensions (ft x ft)
------------------	---------	----------	--------	---------------------	----------------------------	-----------------------	-----------	----------	--------------------	-----------------	--------------------	------------------------------	----------------------

The Summit @ Quadra Village	955 Hillside Avenue	Victoria (Quadra/Hillside)	Owner (Land and Building)	026-085-810		V8T 1Z9	-123.361000	48.439100	2019	YES	Concrete/Steel	257,947 (inclds 31,601 ft ² u/g pkg)	
The Heights @ Mount View	3814 Carey Road	Saanich (Mount View)	Owner (Land) Leased to Baptist Housing Foundation for 25 Yrs)	028-267-214		V8Z 4C4	-123.381400	48.459630	2014	YES	Concrete /Steel	197,735 ft ²	see below
Oak Bay Lodge	2251 Cadboro Bay Road	Oak Bay	Owner (Land and Building)	002-951-053		V8R 5H3	-123.313690	48.432960	1971/1982/20	Unknown	Brick and Concrete	154,020 (ft ²) (inclds u/g parking and partial basement)	see below
Former Blanshard Elementary	950 Kings Road	Victoria (Quadra/Kings)	Owner (Land and Building)	026-085-801		V8T 1W6	-123.360779	48.437683	1968	No	Masonry Blocks, Steel, Concrete, Wood	37,250 ft ²	see below

Dimensions

The Heights (Photo)



The Heights Dimensions (Ground Floor)

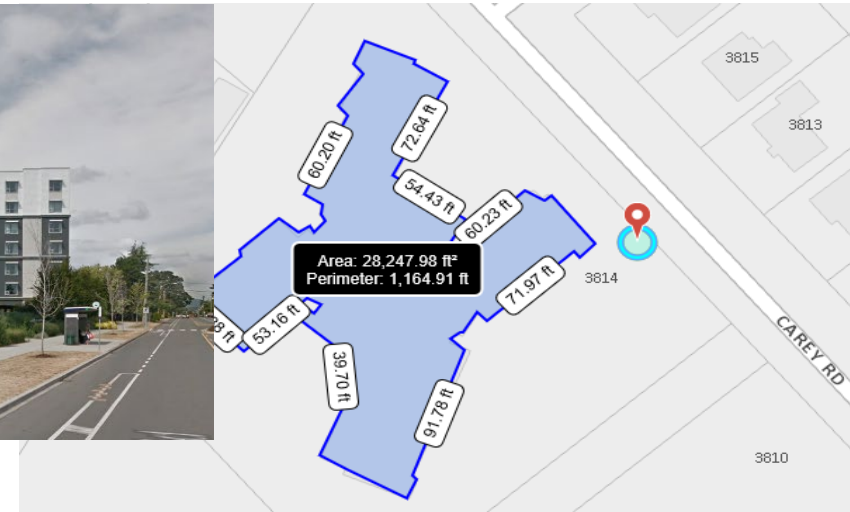

The Summit (Image)



Former Blanshard Elementary (950 Kings) Dimensions (Ground Floor)

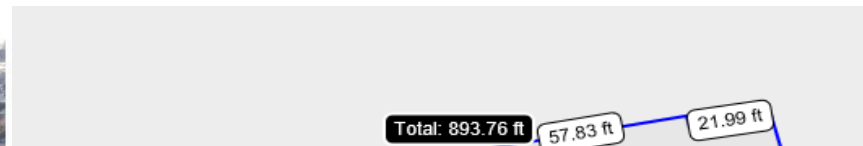

Former Blanshard Elementary (950 Kings) Dimensions (Ground Floor)



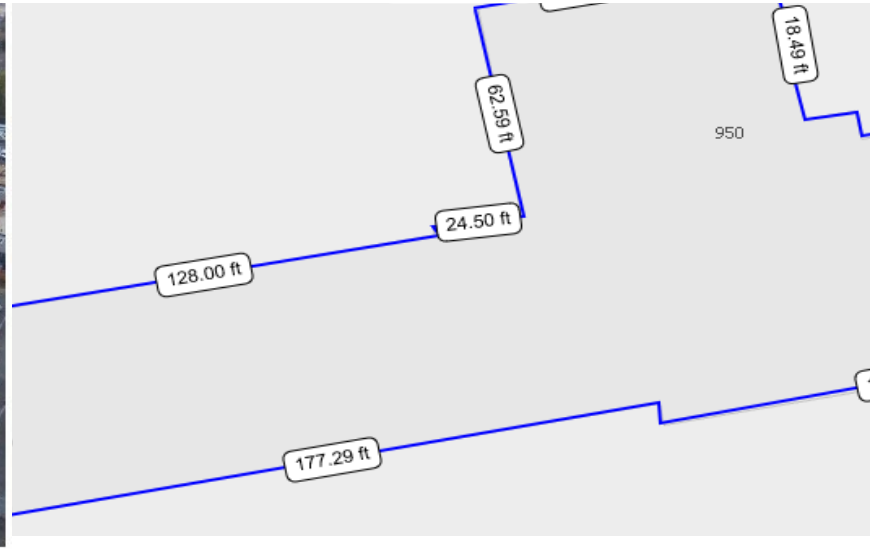

Oak Bay Lodge (Image)

OBLIQUE VIEW NORTH

Oak Bay Lodge Dimensions (Ground Floor)





Building Construction structural frame	Roof - Construction	Roof - Final Surface	No. of Stories (Above Ground)	No. of Stories (incl. basements and parking)	PROTECTION				Occupancy Type
					Sprinklers	Burglar	Fire Protection (Pr) Hydrants	Fire Protection	

Concrete and Steel Structure	Concrete	Modified Bitumen (asphalt, polymer membrane)	4	4.5 (pkg is only under half the building)	yes	yes	yes	yes	Long Term Complex Care Facility
Concrete and Steel Structure	Concrete	Membrane	7	8	yes	yes	yes	yes	Long Term Complex Care Facility
Concrete and Wood Frame	Concrete	Asphalt Roll Roofing, Tar on Cred	2 to 4 (varies due to land grade)	2 to 4	yes	yes	yes	yes	Long Term Care Facility (Vacant)
Masonry Blocks, Steel Support (beams, open web joist etc), Cast in Place Concrete Walls in Areas	Wood and Steel Roof Decks	Built Up Asphalt Roof System	2	2	yes	yes	yes	yes	Non Profit Tenants (Art School/City of Victoria)



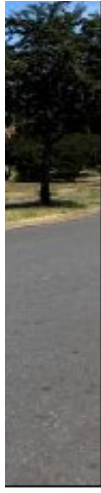

Ref #	DEPT	NAME OF FACILITY	ADDRESS	LOCATION	Estimated Postal Code	Building Structure	Capacity
	Capital Region Housing Corporation (CRHC)	Amberlea (1990 - BCHMC) SAA	3330 Glasgow Avenue	Victoria, BC	V8X 1M6	28 Apt	44
	Capital Region Housing Corporation (CRHC)	Arbutus View (1990 - BCHMC) SAA	2964 Harriet Road, Victoria, BC	Victoria, BC	V9A 1T3	T/H	23
	Capital Region Housing Corporation (CRHC)	Ashlar Manor (1994 - BCHMC) VIC	640 Figgard Street, Victoria, BC	Victoria, BC	V8W 1R6	Apt snr	49
	Capital Region Housing Corporation (CRHC)	Beechwood Park (1986 - CMHC) SAA	3936 Gordon Head Road, Victoria, BC	Victoria, BC	V8P 4X3	23 T/H 25 Apt	48
	Capital Region Housing Corporation (CRHC)	The Birches (1992 - BCHMC) VIC	1466 Hillside Avenue, Victoria, BC	Victoria, BC	V8T 5H5	Apt snr	56
	Capital Region Housing Corporation (CRHC)	The Brambles (1985 - CMHC) SAA	750 Miller Avenue, Victoria, BC	Victoria, BC	V8Z 3C8	T/H	18
	Capital Region Housing Corporation (CRHC)	Brock Place (1999- H/BC) LAN	882 Brock Avenue, Victora, BC	Victoria, BC	V9B 3C6	T/H	30
	Capital Region Housing Corporation (CRHC)	Cairns Park (1996 - H/BC) SID	9882 - 7th Street, Sidney, BC	Sidney, BC	V8L 2V7	T/H	6
	Capital Region Housing Corporation (CRHC)	Caledonia (1993 - BCHMC) VIC	1211 Gladstone Avenue, Victoria, BC	Victoria, BC	V8T 1G5	T/H	18
	Capital Region Housing Corporation (CRHC)	Camosun Place (1989 - BCHMC) VIC	1530 Camosun Street, Victoria, BC	Victoria, BC	V8T 3E4	T/H	8
	Capital Region Housing Corporation (CRHC)	Campus View (1983 - CMHC) SAA	2249 McCoy Road, Victoria, BC	Victoria, BC	V8N 5Z3	T/H	12
	Capital Region Housing Corporation (CRHC)	Carey Lane (1989 - BCHMC) SAA	3910 Carey Road, Victoria, BC	Victoria, BC	V8Z 4E2	T/H	22
	Capital Region Housing Corporation (CRHC)	Carillon Place (1998 - H/BC) VIC	625 Superior Street, Victoria, BC	Victoria, BC	V8V 1V1	T/H	15
	Capital Region Housing Corporation (CRHC)	Castanea Place (1994 - BCHMC) VIC	2840 Gillie Place, 2860 Quadra Street, Victoria, BC	Victoria, BC	V8T 5J5 (F) V8T 4E7 (S)	Apt snr	25 34
	Capital Region Housing Corporation (CRHC)	Cloverhurst (1990 - BCHMC) SAA	955 Cloverdale Avenue, Victoria, BC	Victoria, BC	V8X 2T4	T/H	10
	Capital Region Housing Corporation (CRHC)	Colquitz Green (1989 - BCHMC) SAA	945 Portage Road, Victoria, BC	Victoria, BC	V8Z 1K9	T/H	20
	Capital Region Housing Corporation (CRHC)	Creekside (1992 - BCHMC) SAA	4288 Carey Road, Victoria, BC	Victoria, BC	V8Z 4H2	T/H	24
	Capital Region Housing Corporation (CRHC)	Firgrove (1986 - CMHC) ESQ	921 Devonshire Road, Victoria, BC 741-747-755 Lampson Street	Victoria, BC	V9A 4T9 V9A 6A7	hse, tri dpx,24 T/H	32
	Capital Region Housing Corporation (CRHC)	Gladstone (1989 - BCHMC) VIC	1320 Gladstone Avenue, Victoria, BC	Victoria, BC	V8R 1S1	T/H	14
	Capital Region Housing Corporation (CRHC)	Greenlea (1990 - BCHMC) SAA	788 Shawnee Road, Victoria, BC	Victoria, BC	V8Z 6M9	T/H	21

Capital Region Housing Corporation (CRHC)	Grey Oak Square (1986 - CMHC) SAA	4021 Saanich Road, Victoria, BC	Victoria, BC	V8X 1Z2	T/H	24
Capital Region Housing Corporation (CRHC)	The Hamlet (1990 - BCHMC) VIC	2620 Shakespeare Street, Victoria, BC	Victoria, BC	V8R 4G7	T/H	10
Capital Region Housing Corporation (CRHC)	Harbour Lane (2001 - H/BC) VIC	314 Kingston 324 Kingston Street 515 Pendray Street	Victoria, BC	V8V 4Z4 V8V 1V7 V8V 2A3	10 T/H 18 Apt	28
Capital Region Housing Corporation (CRHC)	The Heathers (1993 - BCHMC) SAA	3169 Tillicum Road, Victoria, BC	Victoria, BC	V9A 2B4	Apt snr & fam	26
Capital Region Housing Corporation (CRHC)	Heron Cove (1993 - BCHMC) NSA	10542 McDonald Park Road, Sidney, BC	Sidney, BC	V8L 3J1	T/H	24
Capital Region Housing Corporation (CRHC)	Hockley House (2021- RHFP) LGF	830 Hockley Avenue, Langford, BC	Langford, BC		Apt	120
Capital Region Housing Corporation (CRHC)	James Yates Gardens (1984 0 CMHC) VIC	1150 Yates Street, Victoria, BC	Victoria, BC	V8V 3M8	Apt	8
Capital Region Housing Corporation (CRHC)	Kings Place (1997 - H/BC) VIC	1070 Kings Road, Victoria, BC V8T 1X1	Victoria, BC		19 T/H 16 Apt	35
Capital Region Housing Corporation (CRHC)	Leblond Place (1996 - BCHMC) VIC	390 Waterfront Crescent (s) 2980 Jutland Road (#1-8) Victoria, BC 2981 JackLadder Lane (# 9-13)	Victoria, BC	V8T 5K3 V8T 5K2 V8T 5K4	28 Apt & 2 g/h 13 T/H 1 hse	43
Capital Region Housing Corporation (CRHC)	Michigan Square (1985 - CMHC) VIC	330-336 Michigan Street, Victoria, BC	Victoria, BC	V8V 1R5	44 Apt 17 T/H	62
Capital Region Housing Corporation (CRHC)	Millstream Ridge (2018 - RHFP) LGF	713 Treanor, Langford, BC 715 Treanor, Langford, BC	Victoria, BC	V9B 0X5 V9B 0X6	Apt	132
Capital Region Housing Corporation (CRHC)	Oakwinds (1985 - CMHC) VIC	1311 Hillside Avenue, Victoria, BC 1250 Kings Rd, Victoria, BC 4511 Chatterton Way	Victoria, BC	V8T 2B3 V8T 1X7 V8X 5L7	T/H	50
Capital Region Housing Corporation (CRHC)	Olympic View (1986 - CMHC) SAA	(#1 - #38) (#39 & #40) (#41 - #60)	Victoria, BC	V8X 5L8 V8X 5L9	T/H	60
Capital Region Housing Corporation (CRHC)	Parkview (1989 - BCHMC) SAA	825 Lodi Avenue, Victoria, BC	Victoria, BC	V8Z 6T3	T/H	26
Capital Region Housing Corporation (CRHC)	Parry Place (2008 - H/BC) VIC	408 Parry Street, Victoria, BC	Victoria, BC	V8V 2H7	Apt snr Assist Liv	21
Capital Region Housing Corporation (CRHC)	Pinehurst (1985 - CMHC) VIC	617 Battery Street, Victoria, BC	Victoria, BC	V8V 1E6	1 hse; 9 Apt11 T/H	20
Capital Region Housing Corporation (CRHC)	Portage Place (1983 - CMHC) TVR	210 Island Highway, Victoria, BC	Victoria, BC	V9B 1G2	T/H	17
Capital Region Housing Corporation (CRHC)	Rosewood (1988 - BCHMC) SAA	1827 McKenzie Avenue, Victoria, BC	Victoria, BC	V8N 1A6	Apt snr	44
Capital Region Housing Corporation (CRHC)	Rotary House (1993 - BCHMC) VIC	1855 Quadra Street, Victoria, BC	Victoria, BC	V8T 4B8	Apt snr & fam	41
Capital Region Housing Corporation (CRHC)	Royal Oak Square (1984 - CMHC) SAA	819 Lodi Avenue, Victoria, BC	Victoria, BC	V8Z 6T3	T/H	38
Capital Region Housing Corporation (CRHC)	Spencer Close (2020- RHFP) LGF	2763 Spencer Road, Langford, BC	Langford, BC		Apt	130

Capital Region Housing Corporation (CRHC)	Springtide (1990 - BCHMC) VIC	270 Russell Street, Victoria, BC	Victoria, BC	V9A 3X2	Apt snr	48
Capital Region Housing Corporation (CRHC)	Swanlea (1985 - CMHC) SAA	898 Seven Oaks Road, Victoria, BC	Victoria, BC	V8X 3E7	T/H	14
Capital Region Housing Corporation (CRHC)	The Terraces (1985 - CMHC) VIC	1635 Oak Bay Avenue, Victoria, BC	Victoria, BC	V8R 1B3	T/H	20
Capital Region Housing Corporation (CRHC)	Tillicum Station ((2002 - H/BC) SAA	275/285 Hampton Road, Victoria, BC 3210/3240 Albina Street, Victoria, BC	Victoria, BC	V8Z 1H3 V8Z 3X2	20 T/H 20 Apt	40
Capital Region Housing Corporation (CRHC)	Vergo (2012) SAA	3808 Carey Road, Victoria BC	Victoria, BC	V8Z 4C4	T/H	18
Capital Region Housing Corporation (CRHC)	Viewmont Gardens (1991 - BCHMC) SAA	4450 Viewmont Avenue, Victoria, BC	Victoria, BC	V8Z 5L1	Apt snr	36
Capital Region Housing Corporation (CRHC)	Village On The Green (1984) VIC	1132 Johnson Street, Victoria, BC	Victoria, BC	V8V 3N8	T/H	38
Capital Region Housing Corporation (CRHC)	Westview (2020 - RHFP) SAA	3816 Carey Road, Victoria, BC	Victoria, BC	V8Z 0G4	Apt	73
Capital Region Housing Corporation (CRHC)	West Park (2020- RHFP) VR	1938 West Park Lane, Victoria, BC	Victoria, BC		Apt	152
Capital Region Housing Corporation (CRHC)	Willowdene (1987 - BCHMC) SAA	1821 McKenzie Avenue, Victoria, BC (#1 - #8) (#9 - #15)	Victoria, BC	V8N 6H4 V8N 6H5	T/H	15