

BID DOCUMENTS FOR
Sooke Lake Intake Tower Remediation

5/17/2019
FILE: 115618065

TENDER #: 2019-492

ISSUED BY: _____

Bryan Gallagher, P.Eng.
Stantec Consulting Ltd.
Tel: (250) 388-9161
Fax: (250) 382-0514
Bryan.gallagher@stantec.com

Addendum issued to active tenderers with documents on record **(4 page, including attachments)**.
This is the final addendum that will be issued.

Clarifications and Additions:

1. Page 20 of the Invitation to Tender document is missing space/information relevant to the bid. Can you provide a new format that allows for the tender price to be added and advise what the daily rate is for liquidated damages?
**A: A revised page 20 has been attached to this addendum which can be used to replace page 20 in the tender documents.
Daily rate for liquidated damages is One Thousand Dollars (\$1000.00).**
2. Can you confirm the amount required for the letter of credit (for bid security)?
A: Minimum sum of ten percent (10%) of the Total Tendered Amount, as noted on page 30 of the Invitation to Tender document.
3. Can you confirm if there is cell service at the Intake Tower?
A: Cell service is limited. Recommend use of 2-way radios.
4. What is the preferred gate for access to the site?
A: Preferred access to the site is through the Goldstream gate (Sooke Lake Road).
5. Will the CRD provide access keys to the gates for the duration of the project?
A: Yes. Access keys will be provided with a \$500/key deposit.
6. Will the CRD provide radios for the duration of the project?
A:
 - All Contractors will be required to take a CRD orientation prior to working within the Watershed.
 - CRD will provide a limited number of handheld radios programmed to CRD frequency. Contractor will be able to program truck radios to CRD frequency (at their own cost). Contractors will use their own radio frequency for day to day activities.
7. Confirm specifications for the Motorola ACE 3600 RTU.
A: Please see the attached RTU ordering information with Stantec mark-ups. Note, the last slot has a module but is not used. The CRD has asked to install the spare rather than leave an empty slot.

8. Could you provide the clear dimension between the bridge curbs and what the maximum allowable load for the bridge would be? Can CRD maintenance confirm if a crane truck has been on the bridge recently?

A:

- There is no available information for previous crane trucks on the bridge.
- Refer to notes on drawing 000:
 - Single lane 3.05m width x 45m length
 - H15 load rating. Vehicles loads over 8000 kg to be reviewed by Stantec. Storage not permitted on bridge.
- Further information from bridge record drawings provided below:

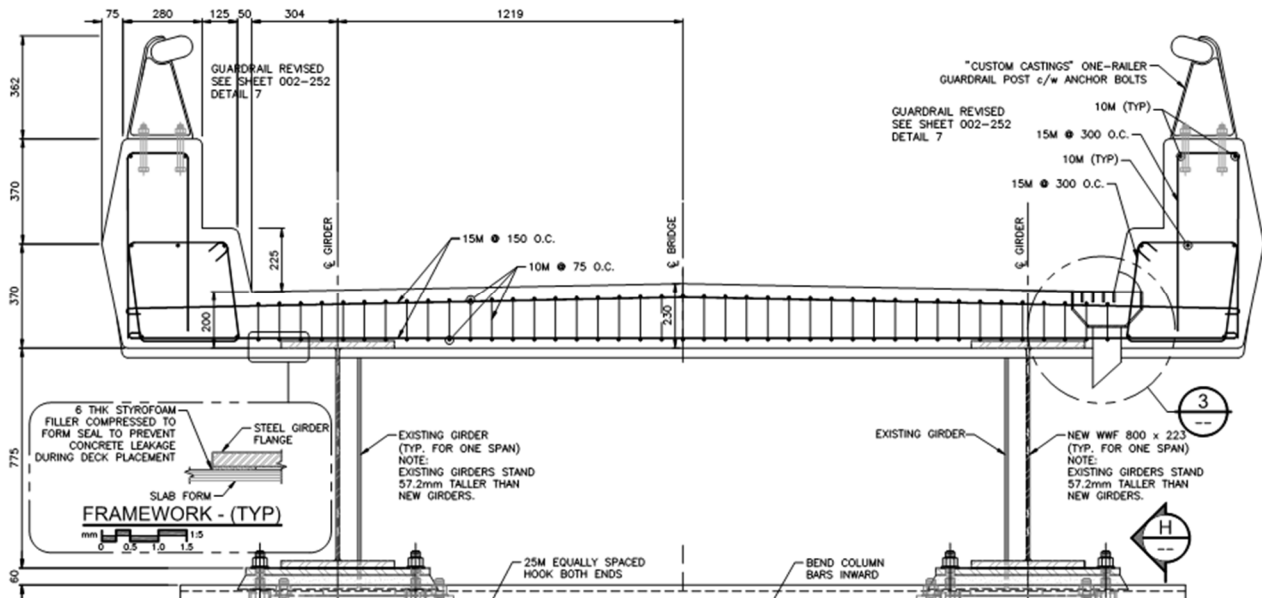

LEGEND

GENERAL NOTES:

1. DESIGN SPECIFICATIONS AASHTO STANDARD SPECIFICATIONS FOR HIGHWAY BRIDGES-1996.

2. DEAD LOAD:
FOR NON-COMPOSITE ACTION 1220kg/m/GIRDER
FOR COMPOSITE ACTION 490kg/m/GIRDER

3. LIVE LOAD:
H15

Distribution:
Capital Regional District Integrated Water Service to post on the bid site

CAPITAL REGIONAL DISTRICT
Sooke Lake Intake Tower - Remediation, 2019-492

The undersigned Tenderer, having carefully read and examined the Instructions to Tenderers, Tender Form and Annexures, Contract Agreement, General Conditions, Specifications, Drawings and Addenda hereby agrees to the same, and having carefully examined the locality and the site of the work and having full knowledge of the work required and of the materials to be furnished and used does hereby tender and offer to enter into a Contract to perform and complete the whole of the said works and provide all necessary labour, plant, tools and materials as set forth and in strict accordance with the Specifications, Drawings and other Contract Documents, and to do all therein called for on the terms and conditions and under the provisions therein at the prices which he has entered in the Schedule of Prices and Estimated Quantities at which prices the cost of the works set out therein would amount to a

TOTAL TENDERED AMOUNT of \$ _____ (including GST) (lawful money of Canada).

The undersigned Tenderer agrees to complete the whole of the works within a time, measured in CALENDAR DAYS, after the Notice to Proceed of: 210 _____ (Calendar Days).

The starting date for the commencement of work shall be FOURTEEN (14) CALENDAR DAYS after the date stated in the "Notice to Proceed" letter signed by the General Manager.

The undersigned Tenderer hereby agrees to pay the sum of **[One Thousand Dollars (\$1000.00)]** as liquidated damages to the Capital Regional District for each and every CALENDAR DAY that he the Contractor exceeds the number of CALENDAR DAYS stipulated upon the Tender Form to reach substantial completion for this Contract.

The undersigned Tenderer hereby agrees that the said Schedule of Prices and Estimated Quantities and Total Tendered Amount include and cover all applicable duties, taxes and handling charges incidental to and forming part of this Contract.

The undersigned Tenderer hereby agrees to submit to the Owner certified copies of all LIABILITY INSURANCE and PROPERTY INSURANCE policies and certificates required and specified in the General Conditions of the Contract forming part of the Contract, all within a period of FOURTEEN (14) CALENDAR DAYS after the date of the written notification of the acceptance of his tender and prior to the commencement of work or supply of materials.

The undersigned Tenderer acknowledges that the Owner shall have the right to reject any or all tenders for any reason or to accept any tender which the Owner in its sole unrestricted discretion deems most advantageous to itself. By submitting a tender, the Tenderer acknowledges the Owner's rights under this clause and absolutely waives any right of action against the Owner and its consultants for the Owner's failure to accept the Tenderer's tender.

The undersigned Tenderer hereby agrees that he has made this tender without any connection, knowledge, comparison of figures, or arrangement with any other person or persons submitting tenders for this Contract, and that this tender is without collusion or fraud.

The undersigned Tenderer hereby agrees that once the tenders for this Contract have been opened, this tender and offer constituted hereby shall not be revoked before EITHER acceptance thereof by the owner OR the expiration of SIXTY (60) CALENDAR DAYS after the opening of tenders for this Contract whichever shall first occur.

Dated this _____ day of _____, 20__

In the case of an incorporated company:

SIGNED, SEALED AND DELIVERED: _____)

Ordering Information

- 10 Ah Backup Battery V328

CPU Upgrade

(Default CPU is CPU3610)

- ACE CPU3640 V446
- Plug-in SRAM V447

CPU Plug-in Ports

- Plug-in RS232 Port V184
- Plug-in RS 485 PORT V440
- Plug-in Ethernet 10M Port V204
- Plug-in Ethernet 10/100 M Port V212
- Plug-in Radio Port VA00362

Digital Input Modules

- 16 DI FAST 24V DC V265
- 32 DI FAST 24V DC V379
- 16 DI FAST 24V IEC TP2 V117
- 32 DI FAST 24V IEC TP2 V959
- 16 DI 120/230V VA00331AA x3

Relay Output Modules

- 8 DO EE relay 2A V508
- 16 DO EE relay 2A V616 x2
- 8 DO ML relay 2A V314
- 16 DO ML relay 2A V516
- 12 DO EE relay 120/230V VA00348
- 12 DO ML relay 120/230V VA00332

Analog Input Modules

- 8 AI, ± 20 mA V318
- 16AI, ± 20 mA V463 x1
- 8 AI, ± 5 V V741
- 16AI, ± 5 V V742

Analog Output Modules

- 4 AO, ± 20 mA V118

Mixed Input/Output Modules

- 16 DI/DO FET V480
- 32 DI/DO FET V481
- 16 DI 4 DO EE 4 AI, ± 20 mA V245 x2
- 16 DI 4 DO ML 4 AI, ± 20 mA V453

Mixed Analog Modules

- 4AO/8AI ± 20 mA V562
- 4AO/8AI ± 5 V V460