

# SITE PLAN OF LOT 61, SECTION 1, TOWNSHIP 11, RENFREW DISTRICT, PLAN 24755

Civic Address: 16957 Tsonoqua Drive,  
Port Renfrew, B.C.

This plan lies within the Capital Regional District.  
This plan lies within the Capital Assessment Area.

CRD Zone CR-1 (Community Residential-One)



The intended plot size of this plan is 559mm in width by 432mm in height (C size) when plotted at a scale of 1 : 150.

ALL DISTANCES IN METRES

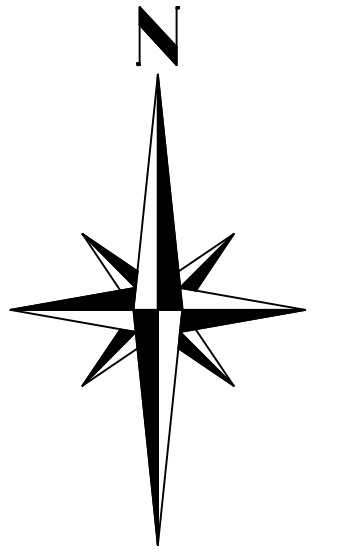

SECTION  
TOWNSHIP

TSONOQUA

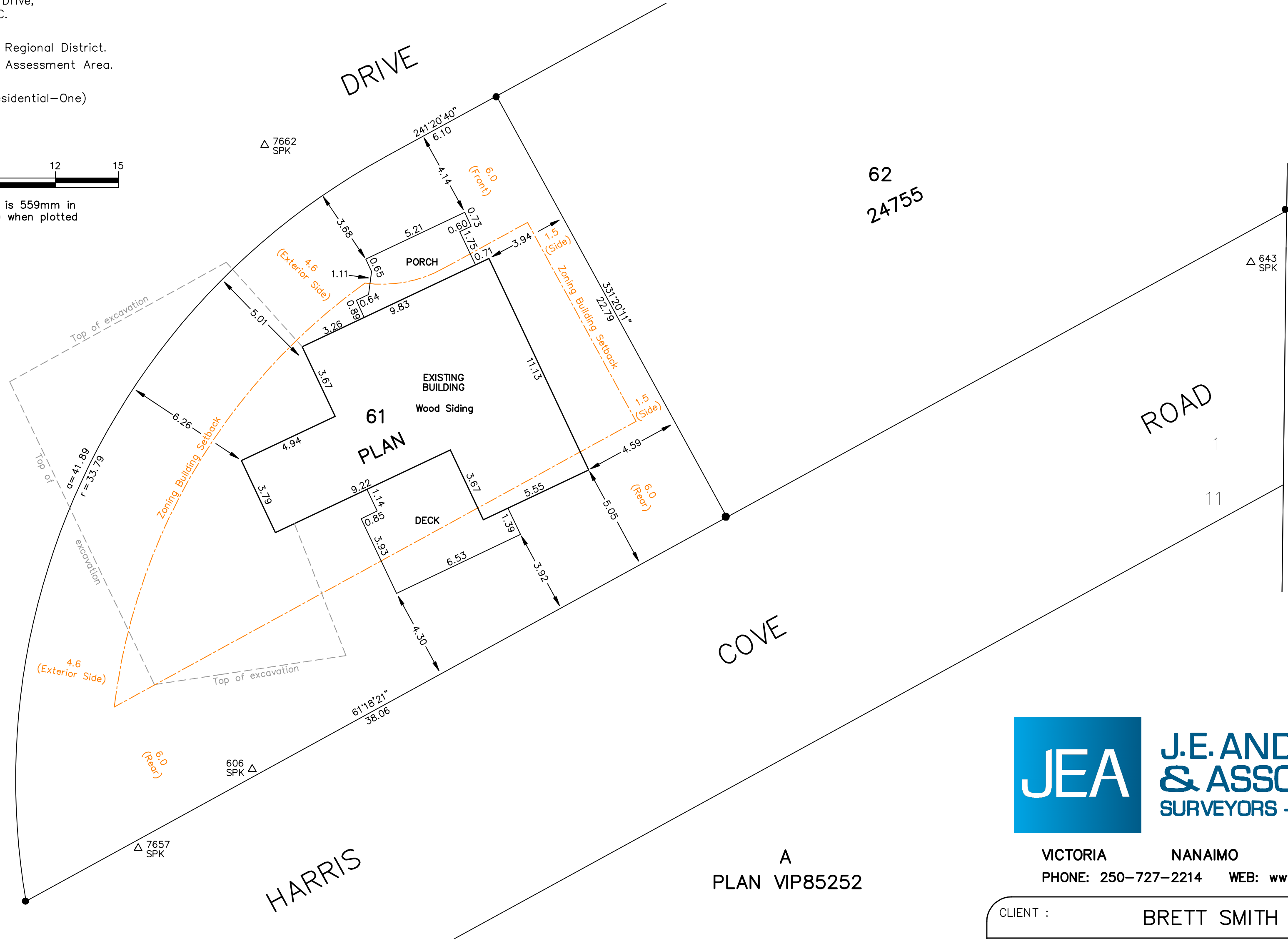

62  
24755

△ 643  
SPK

ROAD

1  
11

PACHEENA  
INDIAN  
RESERVE  
No. 1  
  
CLSR PLAN  
BC 140  
  
CLSR PLAN  
56346

A  
PLAN VIP85252

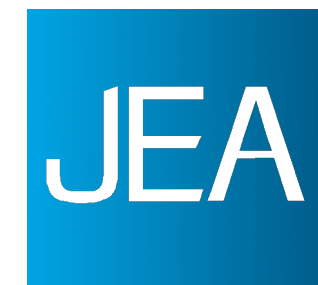

**J.E. ANDERSON  
& ASSOCIATES**  
SURVEYORS - ENGINEERS

VICTORIA NANAIMO PARKSVILLE  
PHONE: 250-727-2214 WEB: www.jeanderson.com

**LEGEND**

- --- Denotes Standard Iron Post Found
- △ --- Denotes Traverse Station Set
- Denotes Zoning Building Envelope

**NOTES:**

Lot dimensions are derived from Field Survey.  
Field survey completed on February 6, 2013.  
Existing building measurements and offsets are to wood siding.  
If this plan is used in digital form, J.E. Anderson & Associates will only assume responsibility for information content shown on original unaltered drawing.  
Building offsets shown on this plan are not to be used to re-establish property lines or corners.

CLIENT :	BRETT SMITH	
PROJECT :	16957 TSONOQUA DRIVE	
SHEET :	SITE PLAN	
LEGAL :	LOT 61, SECTION 1, TOWNSHIP 11, RENFREW DISTRICT, PLAN 24755	
DRAWN BY :	CWG	PROJECT SURVEYOR : COLIN GROVER
SCALE :	HOR. 1 : 150 VERT.	DATE : FEB. 26, 2013.
OUR DRAWING :	PortRenfrew.dwg	LAYOUT: Smith_27894_SitePlan
SERVER :	COMMON\COLIN\24963_PORT_RENFREW\24963LDDPRJ\DWG\	
OUR FILE :	27894	REVISION :