

Sample Drain Tile & Solid Pipe Layout

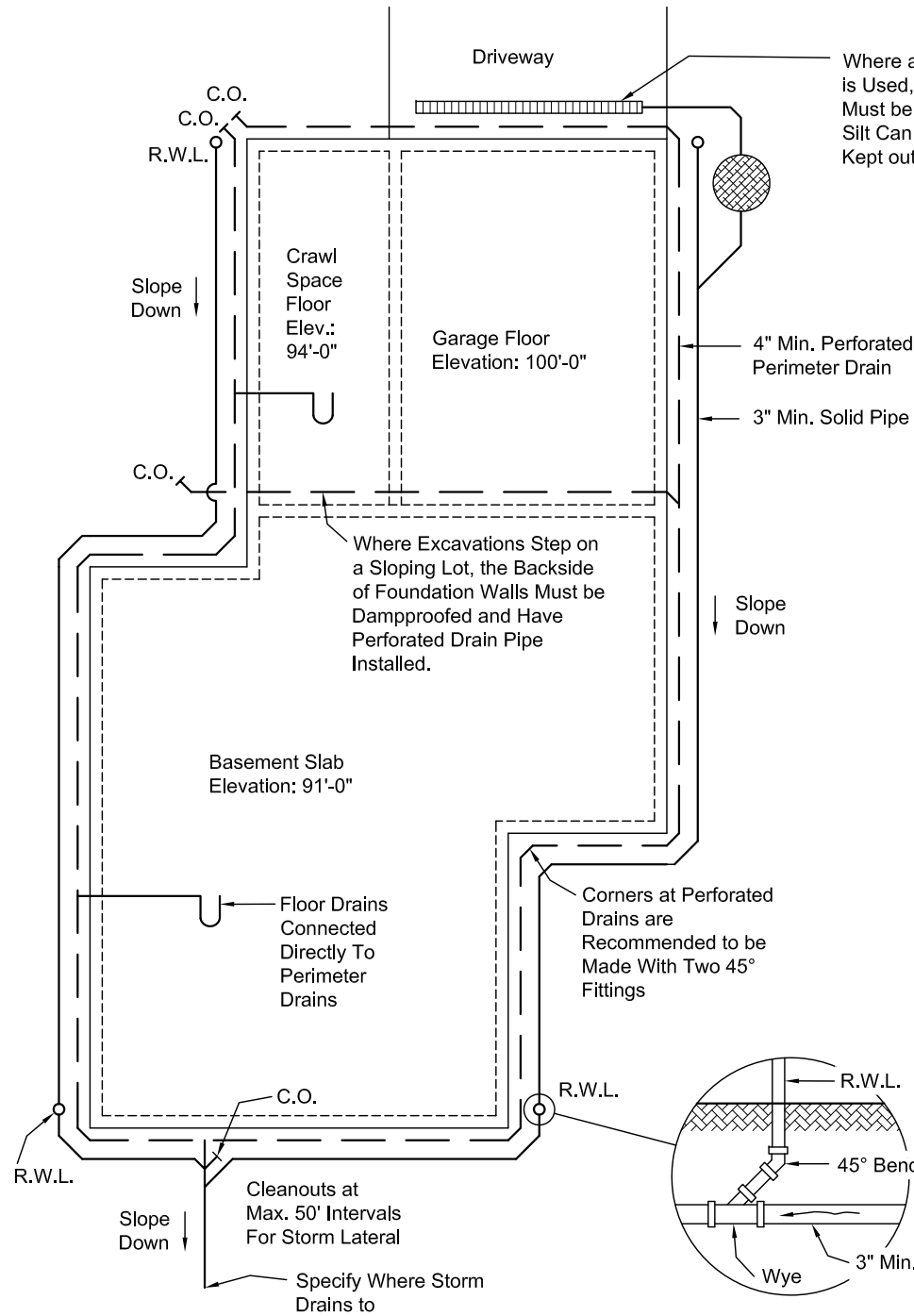

Where a "California Drain" is Used, a Traditional Sump Must be Placed In Line so Silt Can be Intercepted and Kept out of the Systems.

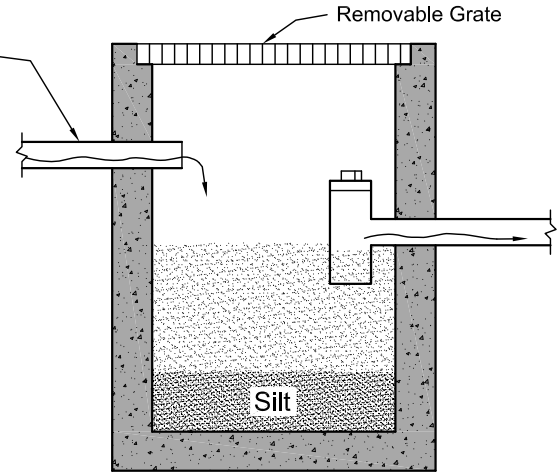

Sump Detail

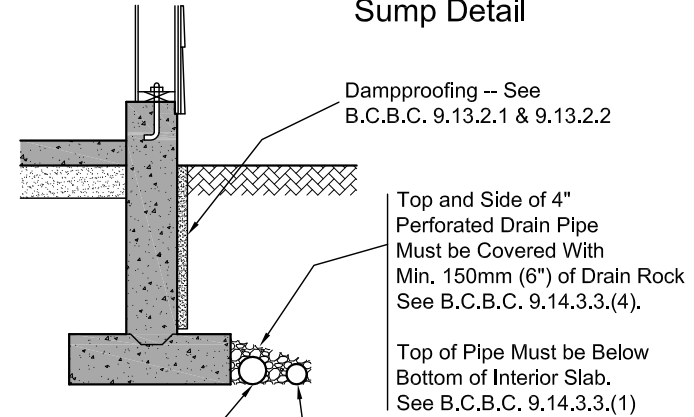

Footing Detail

Min. Slope of 1" in 40'

Min. 3" Pipe w/ Min. Slope of $\frac{1}{4}$ " in 12" (2%)

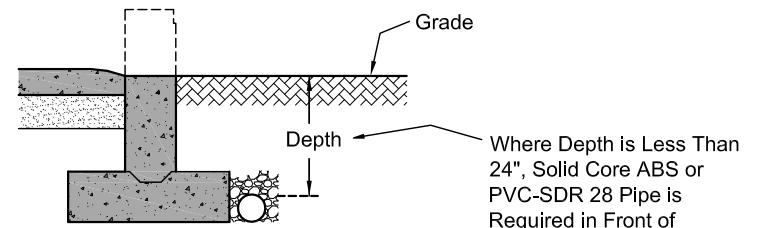

Detail @ Garage Door

